

Soils Map

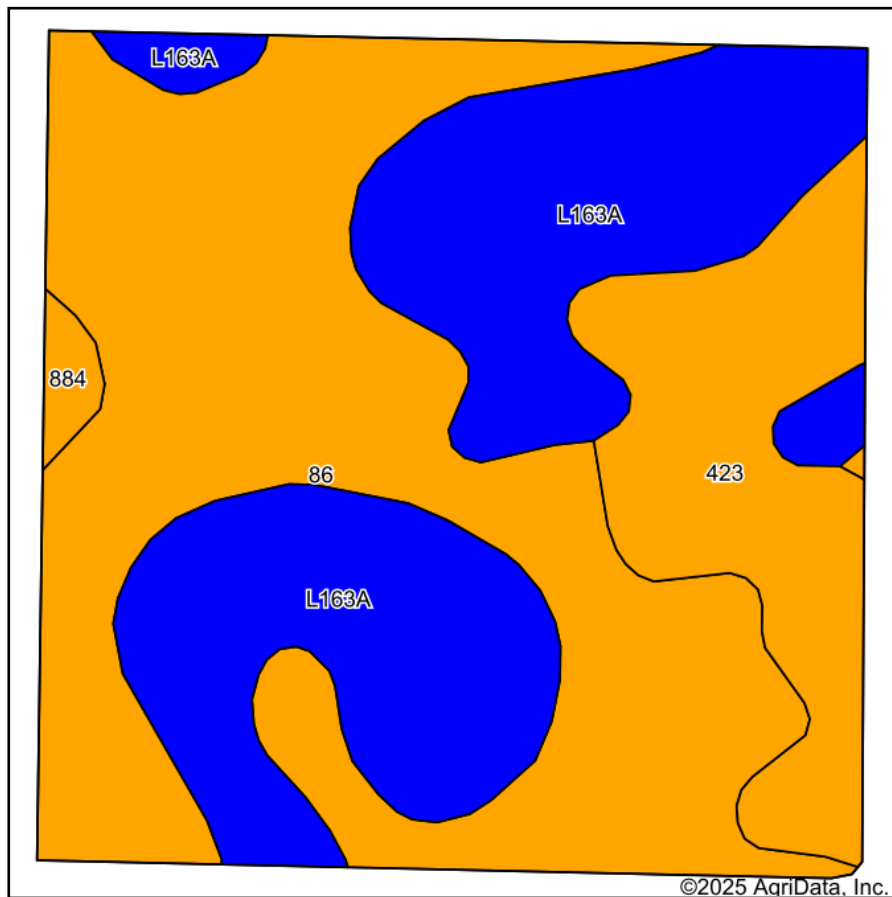

Soils data provided by USDA and NRCS.

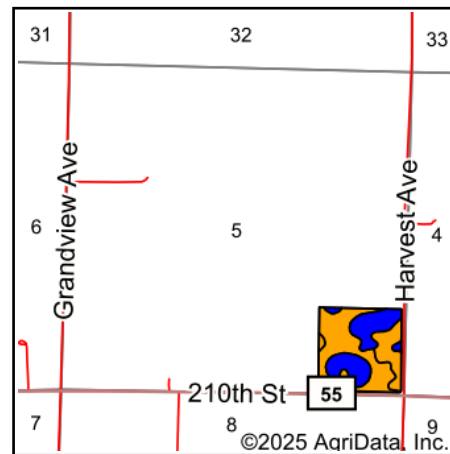

State: **Minnesota**
 County: **Redwood**
 Location: **5-110N-37W**
 Township: **Waterbury**
 Acres: **37.7**
 Date: **4/30/2025**



Maps Provided By:



Area Symbol: MN127, Soil Area Version: 23

Code	Soil Description	Acres	Percent of field	Non-Irr Class Legend	Non-Irr Class *c	Productivity Index
86	Canisteo clay loam, 0 to 2 percent slopes	17.73	47.1%		IIw	93
L163A	Okoboji silty clay loam, 0 to 1 percent slopes	13.57	36.0%		IIIw	86
423	Seaforth loam, 1 to 3 percent slopes	6.01	15.9%		IIIs	95
884	Webster-Delft complex, 0 to 2 percent slopes	0.39	1.0%		IIw	94
Weighted Average					2.36	90.8

*c: Using Capabilities Class Dominant Condition Aggregation Method

Soils data provided by USDA and NRCS.