

Soils Map

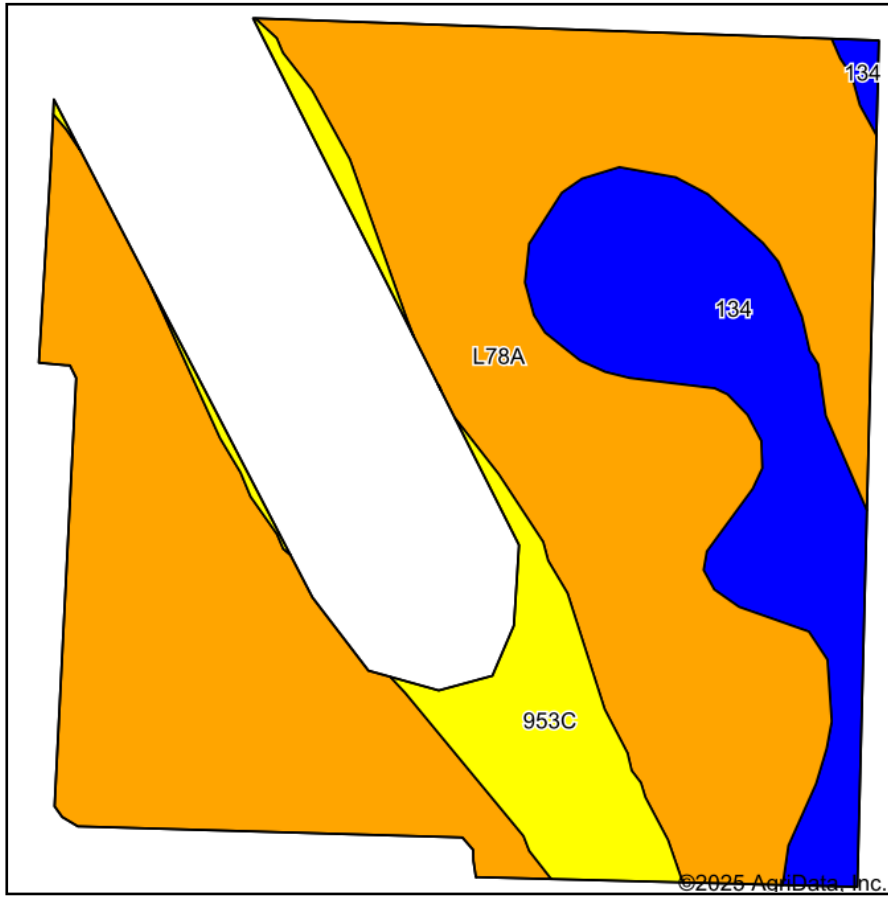

Soils data provided by USDA and NRCS.

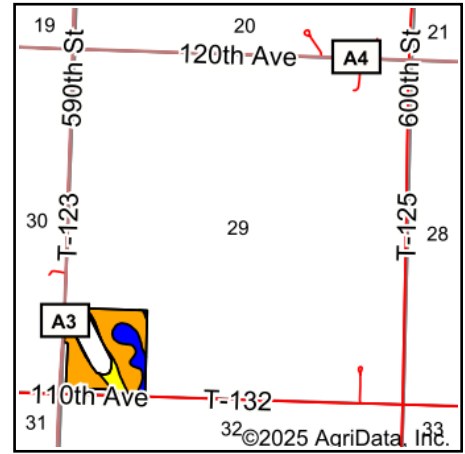

State: **Minnesota**
 County: **Yellow Medicine**
 Location: **29-113N-38W**
 Township: **Echo**
 Acres: **27.98**
 Date: **4/21/2025**



Maps Provided By:



Area Symbol: MN173, Soil Area Version: 19

Code	Soil Description	Acres	Percent of field	Non-Irr Class Legend	Non-Irr Class *c	Productivity Index
L78A	Canisteo clay loam, 0 to 2 percent slopes	20.60	73.6%		IIw	93
134	Okoboji silty clay loam, 0 to 1 percent slopes	4.76	17.0%		IIIw	86
953C	Arvilla-Storden-Ves complex, 6 to 15 percent slopes	2.62	9.4%		IVe	56
Weighted Average					2.36	88.3

*c: Using Capabilities Class Dominant Condition Aggregation Method

Soils data provided by USDA and NRCS.