

Soils Map

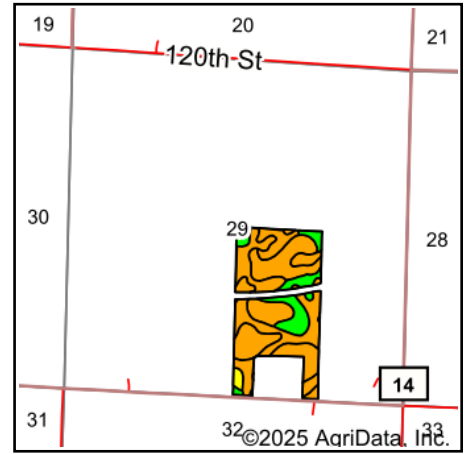

State: **Minnesota**
 County: **Lyon**
 Location: **29-109N-40W**
 Township: **Monroe**
 Acres: **64.61**
 Date: **1/6/2025**

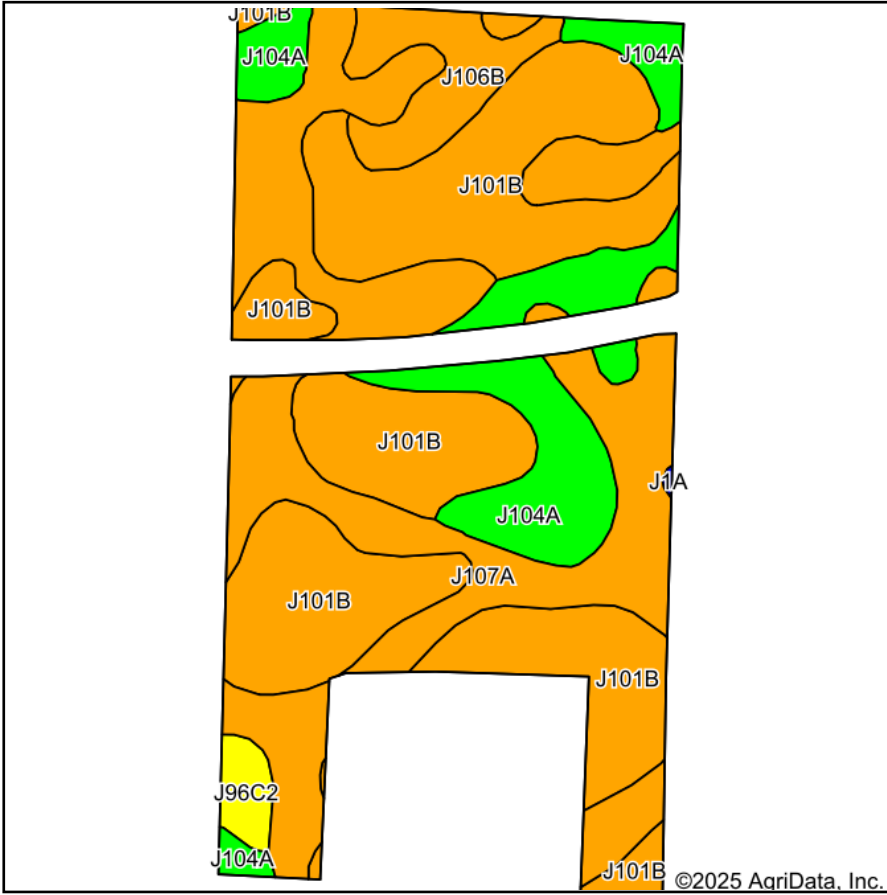

Soils data provided by USDA and NRCS.

Area Symbol: MN083, Soil Area Version: 21

Code	Soil Description	Acres	Percent of field	Non-Irr Class Legend	Non-Irr Class *c	Productivity Index
J101B	Hokans-Svea complex, 1 to 4 percent slopes	28.05	43.4%	Orange	Ile	98
J107A	Lakepark-Roliss-Parnell, depressional, complex, 0 to 3 percent slopes	22.24	34.4%	Orange	IIw	93
J104A	Svea loam, 1 to 3 percent slopes	9.73	15.1%	Green	Ie	99
J106B	Barnes, occasional saturation-Buse-Svea complex, 1 to 6 percent slopes	3.56	5.5%	Orange	Ile	88
J96C2	Barnes-Buse complex, 6 to 12 percent slopes, moderately eroded	1.03	1.6%	Yellow	IVe	80
Weighted Average					1.88	95.6

*c: Using Capabilities Class Dominant Condition Aggregation Method