

Soils Map

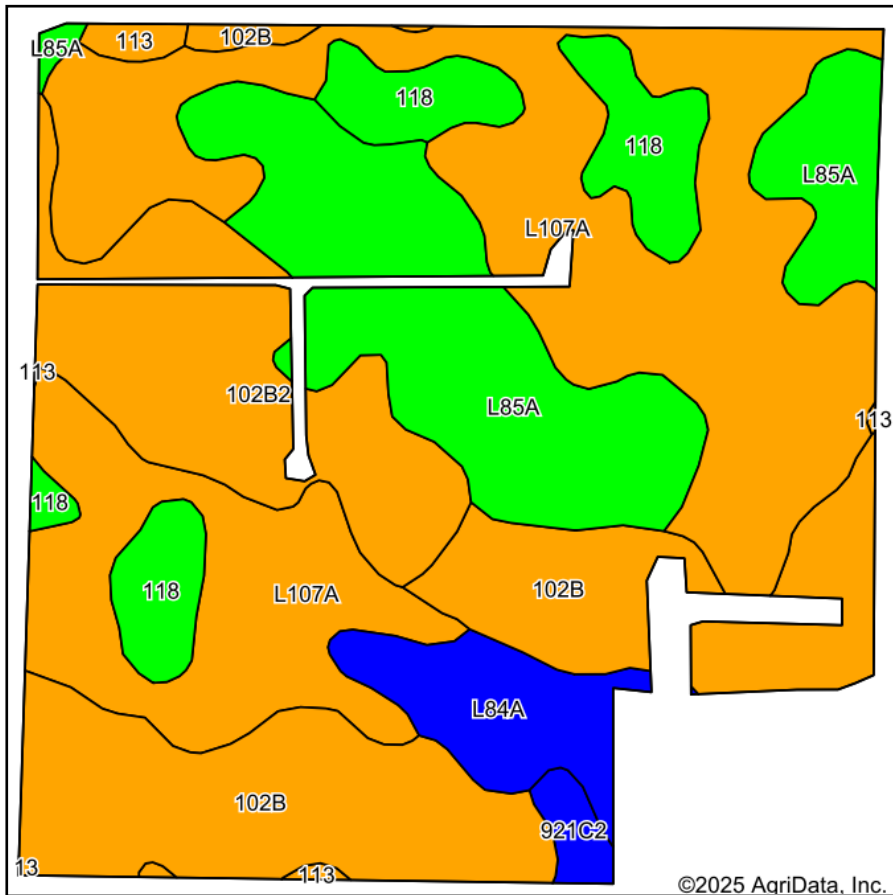

Soils data provided by USDA and NRCS.

©2025 AgriData, Inc.

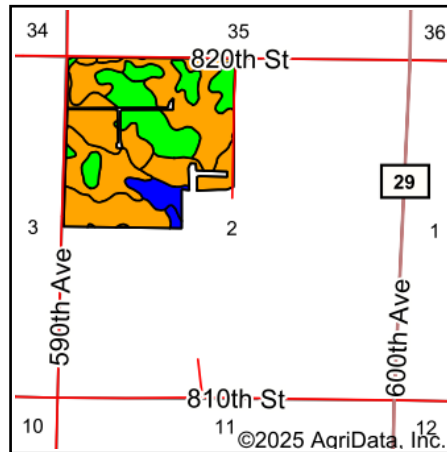

State: **Minnesota**
 County: **Jackson**
 Location: **2-102N-34W**
 Township: **Wisconsin**
 Acres: **140.47**
 Date: **1/21/2025**



Maps Provided By:



© AgriData, Inc. 2023

www.AgriDataInc.com



Area Symbol: MN063, Soil Area Version: 21

Code	Soil Description	Acres	Percent of field	Non-Irr Class Legend	Non-Irr Class *c	Productivity Index
L107A	Canisteo-Glencoe complex, 0 to 2 percent slopes	50.92	36.3%		IIw	91
102B	Clarion loam, 2 to 6 percent slopes	28.25	20.1%		Ile	95
L85A	Nicollet clay loam, 1 to 3 percent slopes	25.62	18.2%		Iw	99
102B2	Clarion loam, 2 to 6 percent slopes, moderately eroded	16.65	11.9%		Ile	95
118	Crippin loam, 1 to 3 percent slopes	10.18	7.2%		Ie	100
L84A	Glencoe clay loam, 0 to 1 percent slopes	6.55	4.7%		IIIw	86
921C2	Clarion-Storden complex, 6 to 10 percent slopes, moderately eroded	1.28	0.9%		IIIe	87
113	Webster clay loam, 0 to 2 percent slopes	1.02	0.7%		IIw	93
Weighted Average					1.80	94.1

*c: Using Capabilities Class Dominant Condition Aggregation Method

Soils data provided by USDA and NRCS.