

Soils Map

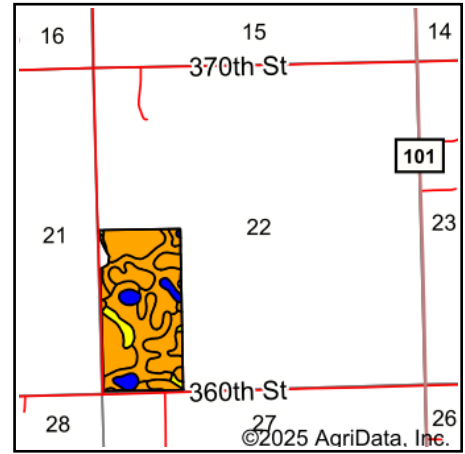

State: **Minnesota**
 County: **Lincoln**
 Location: **22-113N-46W**
 Township: **Hansonville**
 Acres: **78.15**
 Date: **1/7/2025**

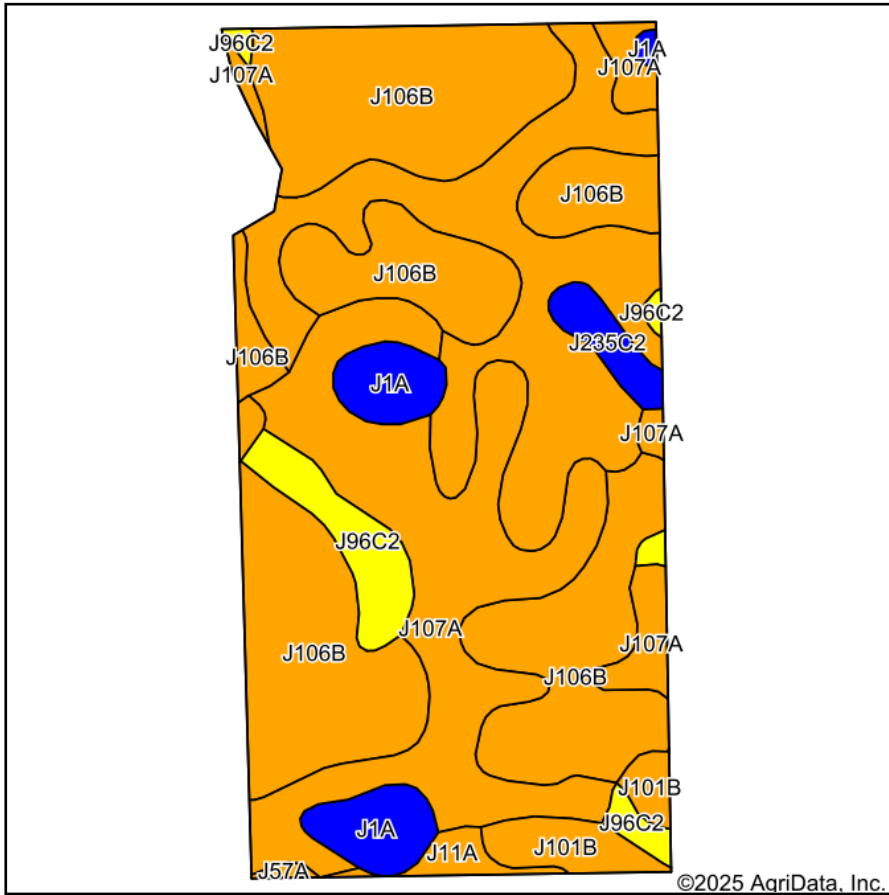

Soils data provided by USDA and NRCS.

Area Symbol: MN081, Soil Area Version: 23

Code	Soil Description	Acres	Percent of field	Non-Irr Class Legend	Non-Irr Class *c	Productivity Index
J106B	Barnes, occasional saturation-Buse-Svea complex, 1 to 6 percent slopes	32.66	41.8%		Ile	88
J107A	Lakepark-Roliss-Parnell, depressional, complex, 0 to 3 percent slopes	18.63	23.8%		IIw	93
J101B	Hokans-Svea complex, 1 to 4 percent slopes	17.15	21.9%		Ile	98
J1A	Parnell silty clay loam, depressional, 0 to 1 percent slopes	3.65	4.7%		IIIw	86
J96C2	Barnes-Buse complex, 6 to 12 percent slopes, moderately eroded	3.56	4.6%		IVe	80
J235C2	Buse-Barnes-Arvilla complex, 6 to 12 percent slopes, moderately eroded	1.27	1.6%		IIIe	64
J11A	Vallers clay loam, 0 to 2 percent slopes	1.08	1.4%		IIw	90
J57A	Balaton loam, 1 to 3 percent slopes	0.15	0.2%		IIs	96
Weighted Average					2.15	90.6

*c: Using Capabilities Class Dominant Condition Aggregation Method