

Soils Map

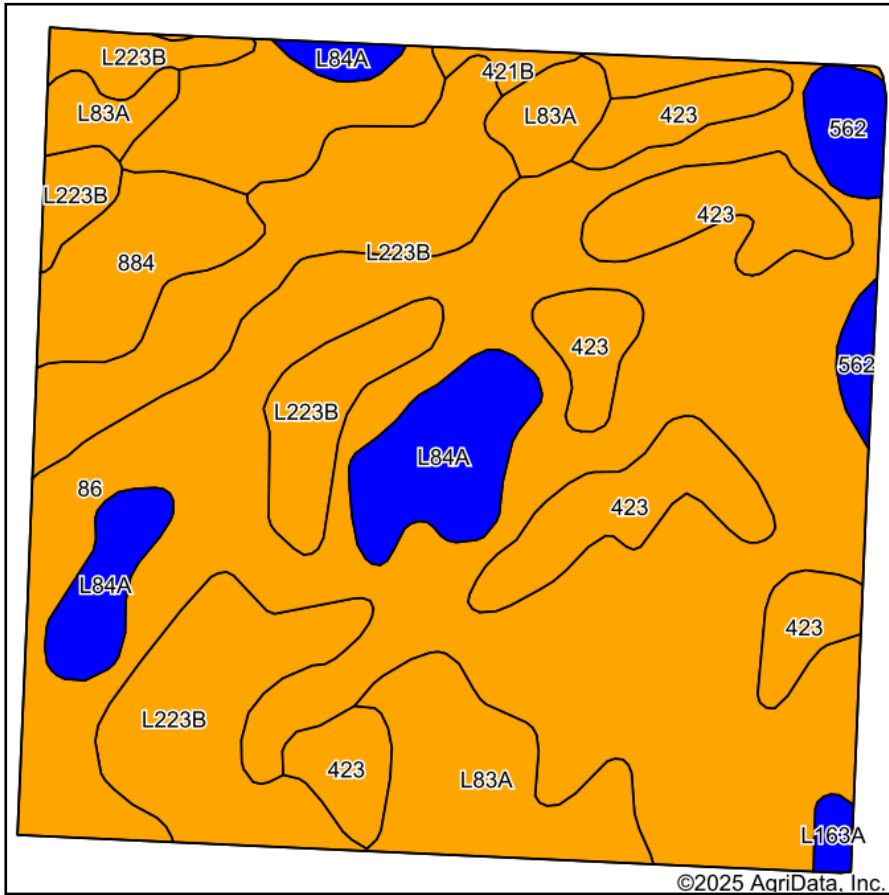

Soils data provided by USDA and NRCS.

©2025 AgriData, Inc.

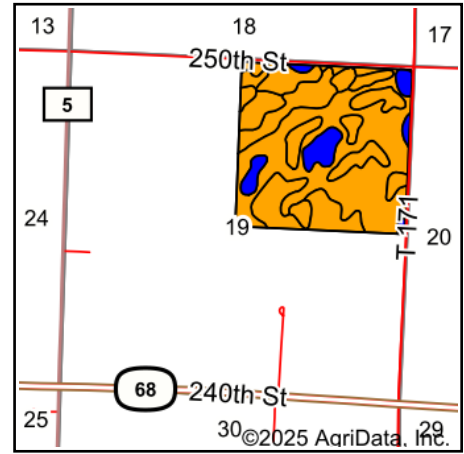

State: **Minnesota**
 County: **Redwood**
 Location: **19-111N-38W**
 Township: **Granite Rock**
 Acres: **161.04**
 Date: **1/8/2025**



Maps Provided By:



© AgriData, Inc. 2023

www.AgriDataInc.com



Area Symbol: MN127, Soil Area Version: 23

Code	Soil Description	Acres	Percent of field	Non-Irr Class Legend	Non-Irr Class *c	Productivity Index
86	Canisteo clay loam, 0 to 2 percent slopes	78.96	49.1%		IIw	93
L223B	Amiret-Swanlake loams, 2 to 6 percent slopes	30.43	18.9%		Ile	92
423	Seaforth loam, 1 to 3 percent slopes	19.12	11.9%		IIs	95
L83A	Webster clay loam, 0 to 2 percent slopes	12.42	7.7%		IIw	93
L84A	Glencoe clay loam, 0 to 1 percent slopes	9.59	6.0%		IIIw	86
884	Webster-Delft complex, 0 to 2 percent slopes	6.03	3.7%		IIw	94
562	Knokke silty clay loam, 0 to 1 percent slopes	3.10	1.9%		IIIw	78
421B	Amiret loam, 2 to 6 percent slopes	0.71	0.4%		Ile	98
L163A	Okoboji silty clay loam, 0 to 1 percent slopes	0.68	0.4%		IIIw	86
Weighted Average					2.08	92.4

*c: Using Capabilities Class Dominant Condition Aggregation Method