

Soils Map

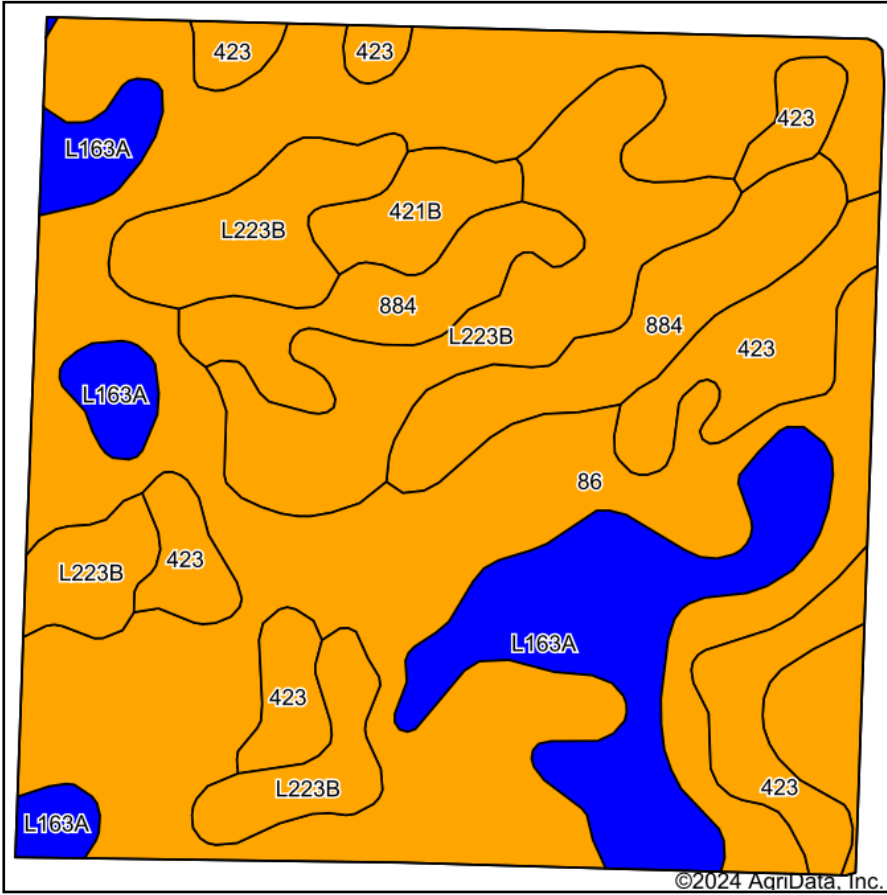

Soils data provided by USDA and NRCS.

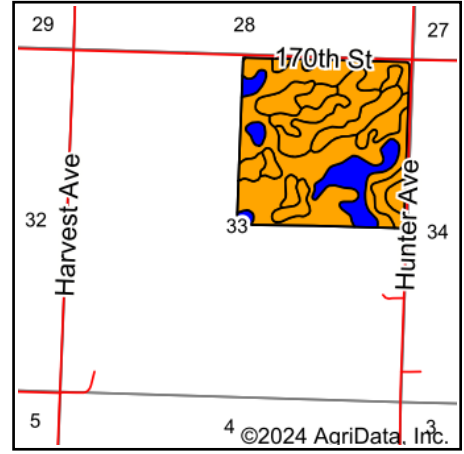

State: **Minnesota**
 County: **Redwood**
 Location: **33-110N-37W**
 Township: **Waterbury**
 Acres: **153.29**
 Date: **11/27/2024**



Area Symbol: MN127, Soil Area Version: 23

Code	Soil Description	Acres	Percent of field	Non-Irr Class Legend	Non-Irr Class *c	Productivity Index
86	Canisteo clay loam, 0 to 2 percent slopes	70.72	46.3%		IIw	93
L223B	Amiret-Swanlake loams, 2 to 6 percent slopes	26.71	17.4%		Ile	92
L163A	Okoboji silty clay loam, 0 to 1 percent slopes	19.52	12.7%		IIIw	86
423	Seaforth loam, 1 to 3 percent slopes	18.14	11.8%		IIs	95
884	Webster-Delft complex, 0 to 2 percent slopes	14.76	9.6%		IIw	94
421B	Amiret loam, 2 to 6 percent slopes	3.44	2.2%		Ile	98
Weighted Average					2.13	92.4

*c: Using Capabilities Class Dominant Condition Aggregation Method

Soils data provided by USDA and NRCS.