

Soils Map

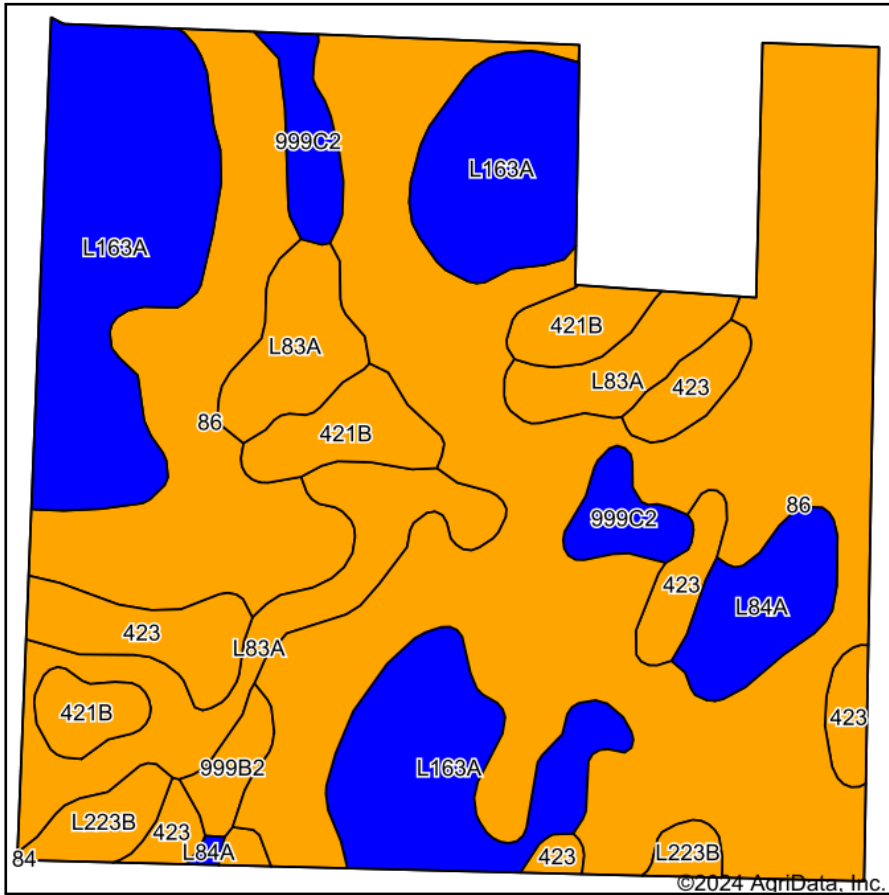

Soils data provided by USDA and NRCS.

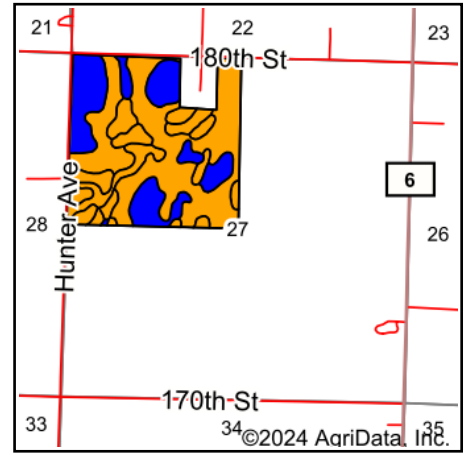

State: **Minnesota**
 County: **Redwood**
 Location: **27-110N-37W**
 Township: **Waterbury**
 Acres: **148.63**
 Date: **11/27/2024**



Area Symbol: MN127, Soil Area Version: 23

Code	Soil Description	Acres	Percent of field	Non-Irr Class Legend	Non-Irr Class *c	Productivity Index
86	Canisteo clay loam, 0 to 2 percent slopes	72.91	49.0%		IIw	93
L163A	Okoboji silty clay loam, 0 to 1 percent slopes	31.61	21.3%		IIIw	86
L83A	Webster clay loam, 0 to 2 percent slopes	15.50	10.4%		IIw	93
423	Seaforth loam, 1 to 3 percent slopes	9.47	6.4%		IIs	95
421B	Amiret loam, 2 to 6 percent slopes	6.55	4.4%		IIe	98
L84A	Glencoe clay loam, 0 to 1 percent slopes	4.34	2.9%		IIIw	86
999C2	Storden-Estherville-Ves loams, 6 to 12 percent slopes, eroded	4.17	2.8%		IIIe	63
L223B	Amiret-Swanlake loams, 2 to 6 percent slopes	2.66	1.8%		IIe	92
999B2	Ves-Estherville-Storden complex, 3 to 6 percent slopes, eroded	1.42	1.0%		IIe	69
Weighted Average					2.27	90.6

*c: Using Capabilities Class Dominant Condition Aggregation Method