

Soils Map

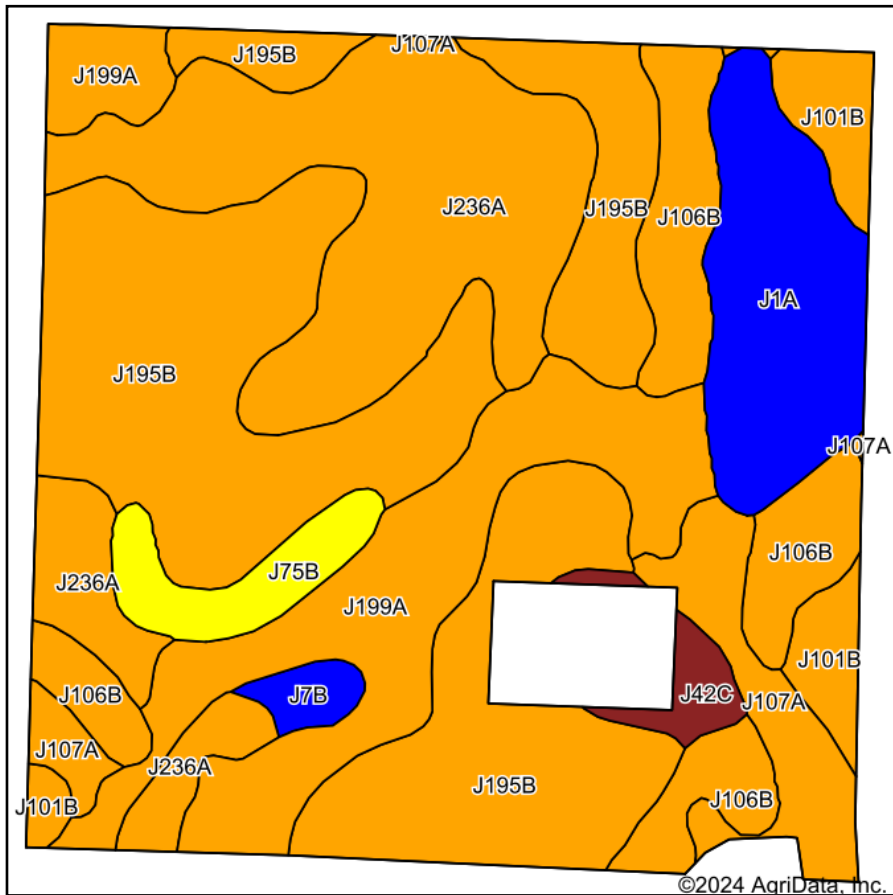

Soils data provided by USDA and NRCS.

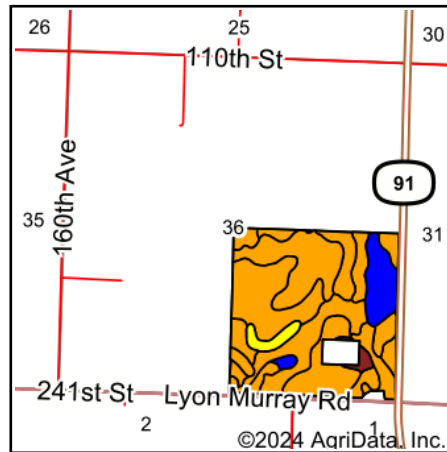

State: **Minnesota**
 County: **Lyon**
 Location: **36-109N-43W**
 Township: **Shelburne**
 Acres: **147.31**
 Date: **10/16/2024**



© AgriData, Inc. 2023 www.AgriDataInc.com

Area Symbol: MN083, Soil Area Version: 20

Code	Soil Description	Acres	Percent of field	Non-Irr Class Legend	Non-Irr Class *c	Productivity Index
J195B	Poinsett-Waubay silty clay loams, 1 to 6 percent slopes	49.25	33.4%		Ile	93
J236A	Highpoint Lake silty clay, 0 to 2 percent slopes	29.87	20.3%		IIs	90
J199A	Fulda silty clay, 0 to 2 percent slopes	21.68	14.7%		IIw	86
J106B	Barnes, occasional saturation-Buse-Svea complex, 1 to 6 percent slopes	13.35	9.1%		Ile	88
J1A	Parnell silty clay loam, depressional, 0 to 1 percent slopes	12.54	8.5%		IIIw	86
J107A	Lakepark-Roliss-Parnell, depressional, complex, 0 to 3 percent slopes	7.63	5.2%		IIw	93
J101B	Hokans-Svea complex, 1 to 4 percent slopes	5.44	3.7%		Ile	98
J75B	Renshaw-Fordville loams, coteau, 2 to 6 percent slopes	4.18	2.8%		IVs	56
J42C	Sandberg-Arvilla complex, 6 to 12 percent slopes	2.00	1.4%		VIIs	38
J7B	Sverdrup sandy loam, 2 to 6 percent slopes	1.37	0.9%		IIIe	49
Weighted Average					2.21	88.3

*c: Using Capabilities Class Dominant Condition Aggregation Method

Soils data provided by USDA and NRCS.