

Soils Map

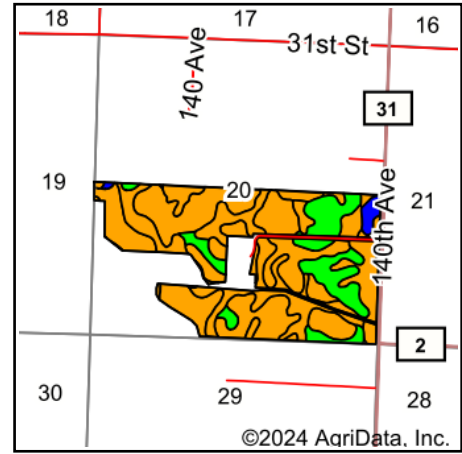

State: **Minnesota**
 County: **Murray**
 Location: **20-105N-41W**
 Township: **Iona**
 Acres: **237.02**
 Date: **10/2/2024**

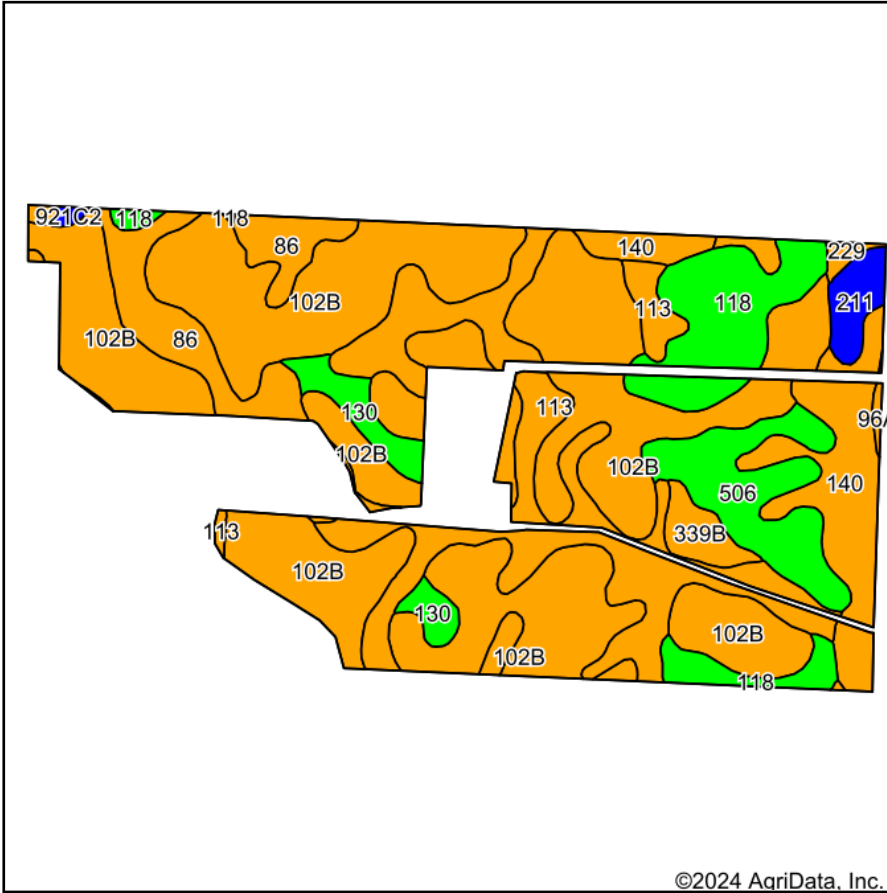

Soils data provided by USDA and NRCS.

©2024 AgriData, Inc.

Area Symbol: MN101, Soil Area Version: 23

Code	Soil Description	Acres	Percent of field	Non-Irr Class Legend	Non-Irr Class *c	Productivity Index
102B	Clarion loam, 2 to 6 percent slopes	116.30	49.1%		Ile	95
113	Webster clay loam, 0 to 2 percent slopes	38.10	16.1%		IIw	93
140	Spicer silty clay loam, 0 to 2 percent slopes	18.76	7.9%		IIw	91
118	Crippin loam, 1 to 3 percent slopes	18.66	7.9%		Ie	100
86	Canisteo clay loam, 0 to 2 percent slopes	15.08	6.4%		IIw	93
506	Overly silty clay loam	14.45	6.1%		I	100
130	Nicollet clay loam, 1 to 3 percent slopes	5.98	2.5%		Iw	99
211	Lura silty clay, 0 to 1 percent slopes	3.66	1.5%		IIIw	81
339B	Fordville loam, 2 to 6 percent slopes	3.42	1.4%		Ile	63
229	Waldorf silty clay loam, 0 to 2 percent slopes	1.76	0.7%		IIw	85
96A	Collinwood silty clay loam, 1 to 3 percent slopes	0.43	0.2%		IIw	86
921C2	Clarion-Storden complex, 6 to 10 percent slopes, moderately eroded	0.42	0.2%		IIIe	87
Weighted Average					1.85	94.3

*c: Using Capabilities Class Dominant Condition Aggregation Method

Soils data provided by USDA and NRCS.