

# Soils Map

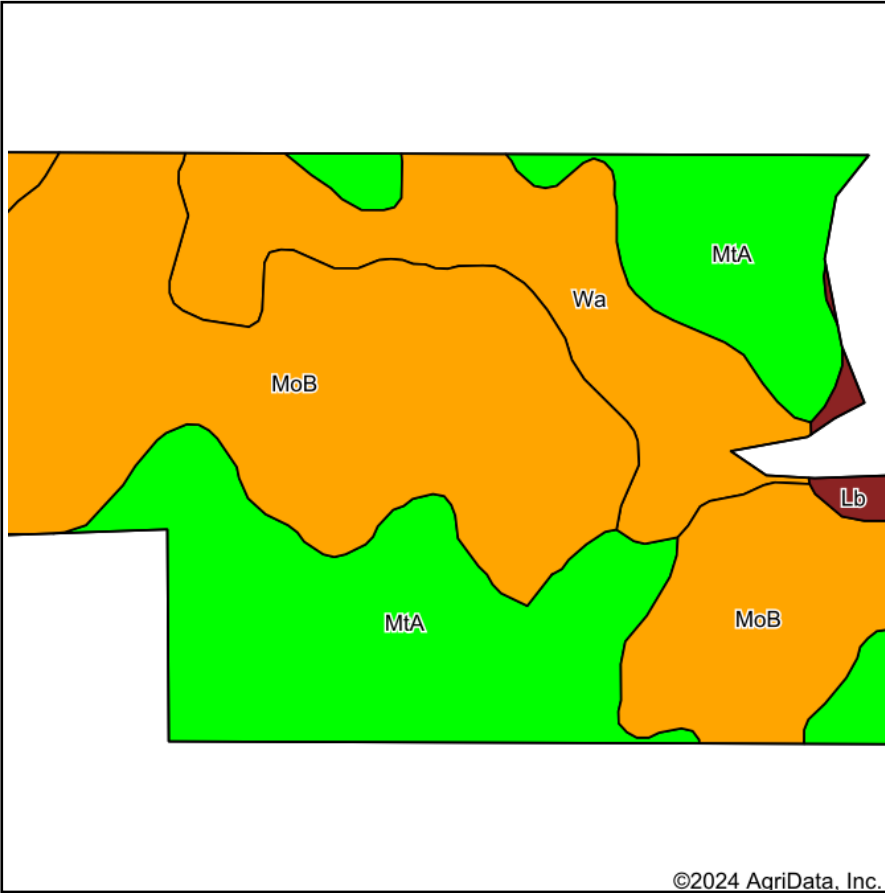

Soils data provided by USDA and NRCS.

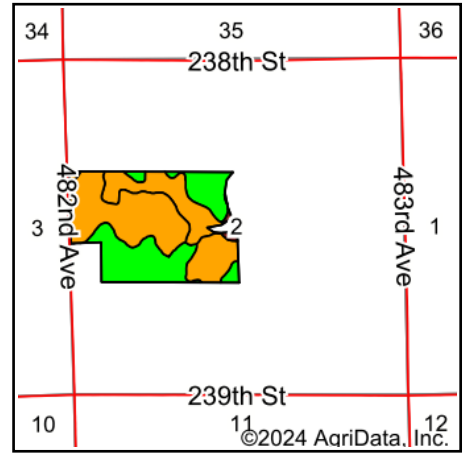

State: **South Dakota**  
 County: **Moody**  
 Location: **2-105N-48W**  
 Township: **Blinsmon**  
 Acres: **96.43**  
 Date: **7/30/2024**



Maps Provided By:



Area Symbol: SD101, Soil Area Version: 27

Code	Soil Description	Acres	Percent of field	Non-Irr Class Legend	Non-Irr Class *c	Irr Class *c	Productivity Index
MoB	Moody silty clay loam, cool, 2 to 6 percent slopes	44.28	45.9%		Ile		87
MtA	Moody-Trent complex, 0 to 2 percent slopes	33.80	35.1%		I	I	95
Wa	Wakonda-Chancellor complex, 0 to 2 percent slopes	17.38	18.0%		Ils		83
Lb	Lamo silty clay loam, frequently flooded	0.97	1.0%		VIw		34
<b>Weighted Average</b>					<b>1.69</b>	<b>*-</b>	<b>88.6</b>

\*c: Using Capabilities Class Dominant Condition Aggregation Method

\*- Irr Class weighted average cannot be calculated on the current soils data due to missing data.

Soils data provided by USDA and NRCS.