

Soils Map

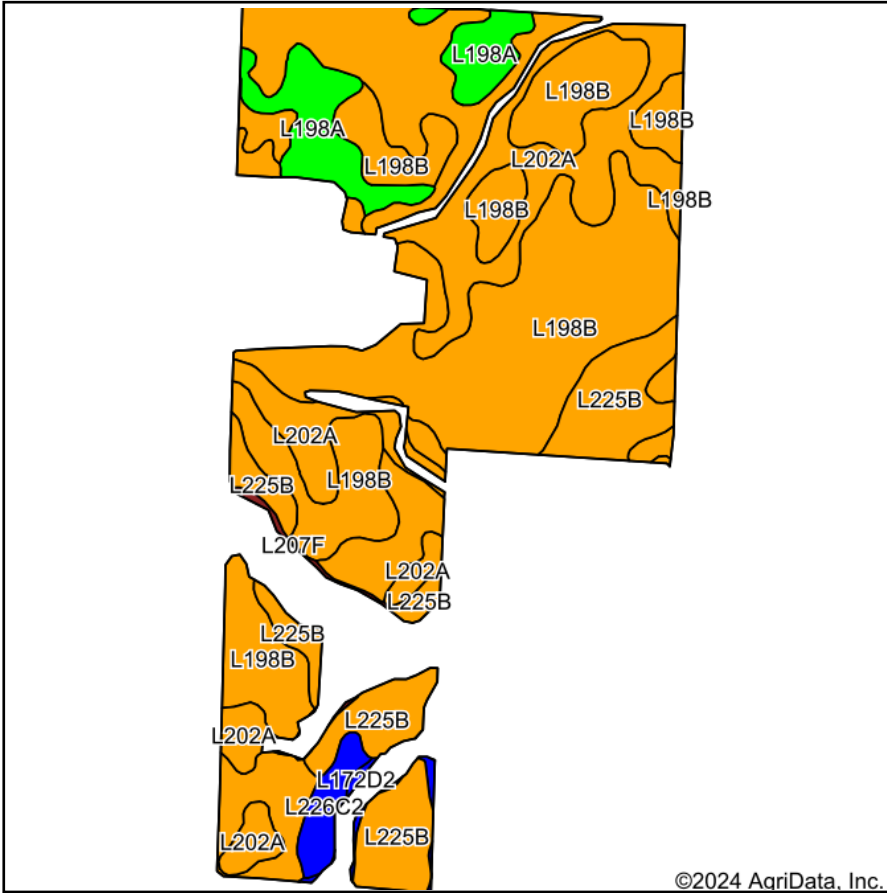

Soils data provided by USDA and NRCS.

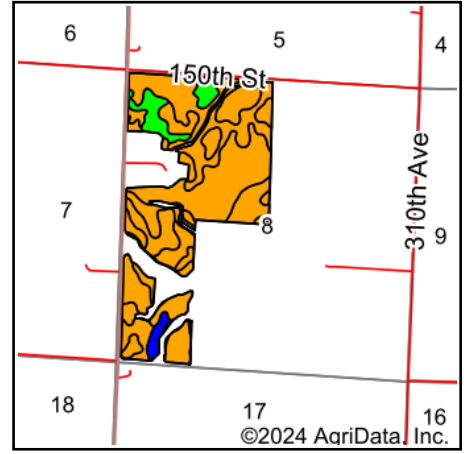

State: **Minnesota**
 County: **Lyon**
 Location: **8-109N-40W**
 Township: **Monroe**
 Acres: **188.9**
 Date: **8/8/2024**



Area Symbol: MN083, Soil Area Version: 20

Code	Soil Description	Acres	Percent of field	Non-Irr Class Legend	Non-Irr Class *c	Productivity Index
L198B	North Twin-Walnut Grove complex, 1 to 4 percent slopes	85.25	45.0%		Ile	94
L202A	Pell Creek-Romnell complex, 0 to 2 percent slopes	53.58	28.4%		IIw	89
L225B	Annton-North Twin complex, 3 to 6 percent slopes	31.67	16.8%		Ile	91
L198A	North Twin-Walnut Grove complex, 0 to 2 percent slopes	13.36	7.1%		Iw	96
L226C2	Annton-Storden, firm till complex, 6 to 12 percent slopes, moderately eroded	3.46	1.8%		IIIe	79
L172D2	Storden, firm till-Annton complex, 12 to 18 percent slopes, moderately eroded	0.89	0.5%		IIIe	64
L207F	Belview-Ridgeton complex, 18 to 40 percent slopes, firm till substratum	0.69	0.4%		Vle	31
Weighted Average					1.97	91.6

*c: Using Capabilities Class Dominant Condition Aggregation Method