

Soils Map

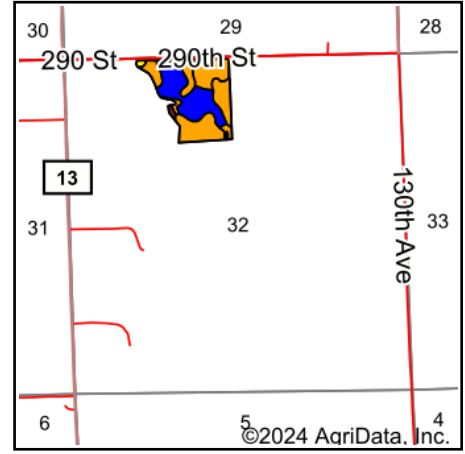

State: **Minnesota**
 County: **Lyon**
 Location: **32-112N-43W**
 Township: **Nordland**
 Acres: **31.36**
 Date: **6/10/2024**

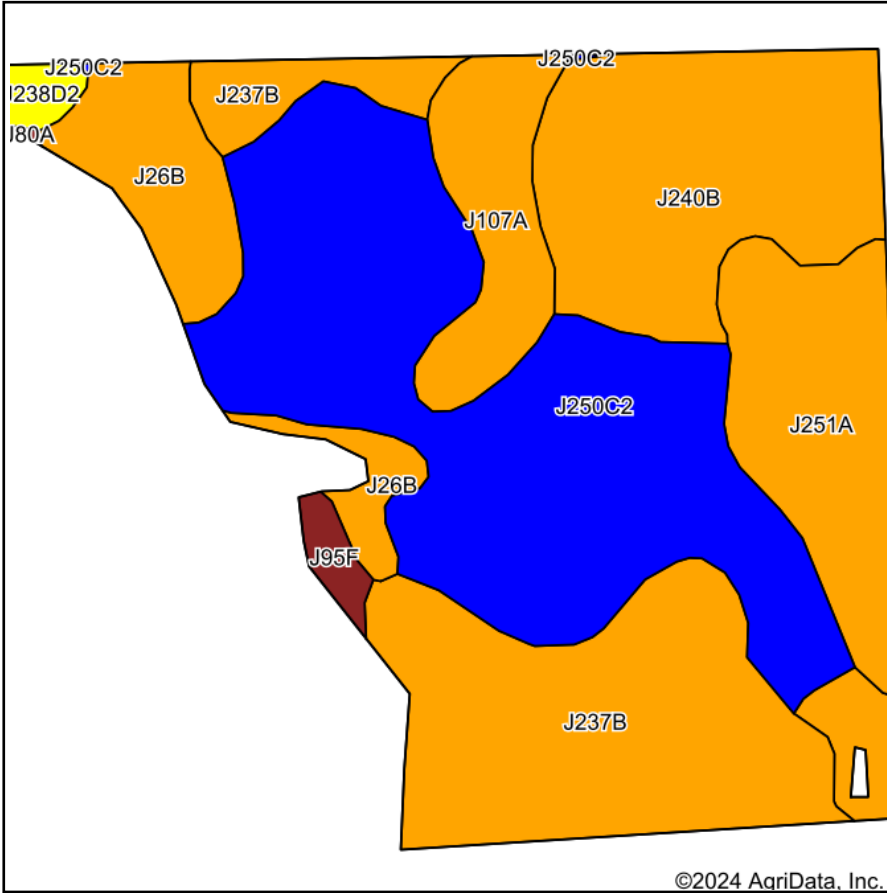

Soils data provided by USDA and NRCS.

©2024 AgriData, Inc.

Area Symbol: MN083, Soil Area Version: 20

Code	Soil Description	Acres	Percent of field	Non-Irr Class Legend	Non-Irr Class *c	Productivity Index
J250C2	Forman-Buse complex, 6 to 12 percent slopes, moderately eroded	10.49	33.6%		IIIe	81
J237B	Brensall-Tress complex 1 to 4 percent slopes	6.75	21.5%		IIe	95
J240B	Forman-Aastad complex, 3 to 6 percent slopes	5.72	18.2%		IIe	94
J251A	Parnell silty clay loam, firm till, 0 to 2 percent slopes	3.43	10.9%		IIw	94
J26B	Darnen loam, 2 to 6 percent slopes	2.33	7.4%		IIe	99
J107A	Lakepark-Roliss-Parnell, depressional, complex, 0 to 3 percent slopes	2.01	6.4%		IIw	93
J95F	Buse, stony-Wilno complex, 25 to 40 percent slopes	0.32	1.0%		VIIe	17
J238D2	Buse, firm till-Wilno complex, 12 to 18 percent slopes	0.31	1.0%		IVe	63
Weighted Average					2.41	89.1

*c: Using Capabilities Class Dominant Condition Aggregation Method