

Soils Map

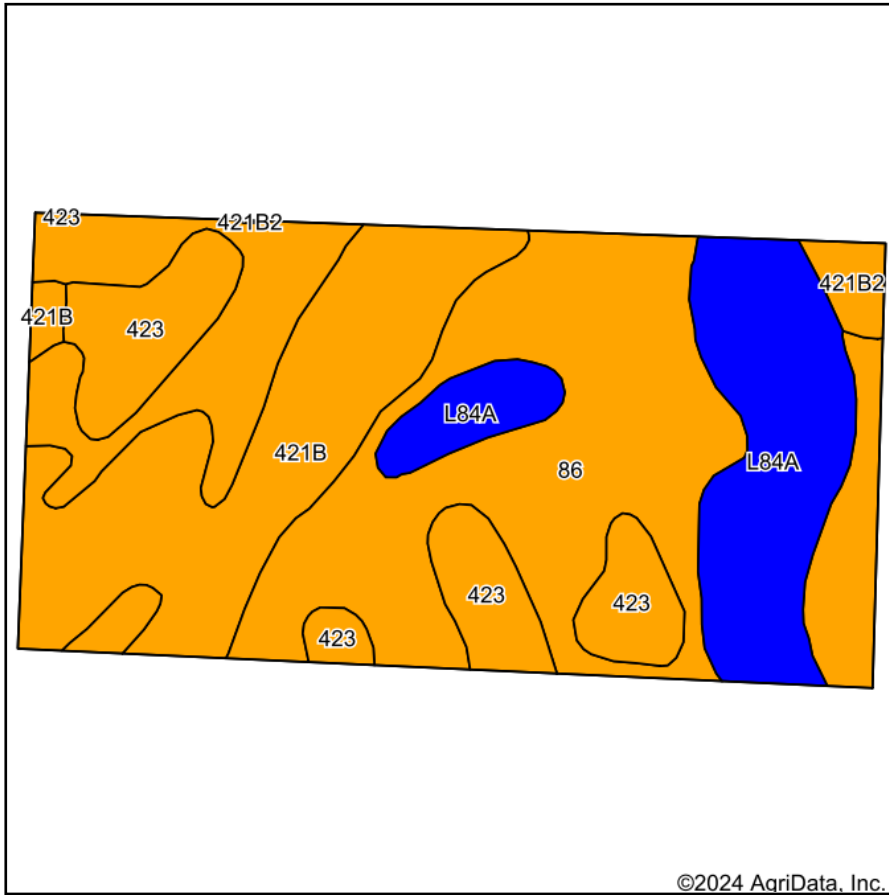

Soils data provided by USDA and NRCS.

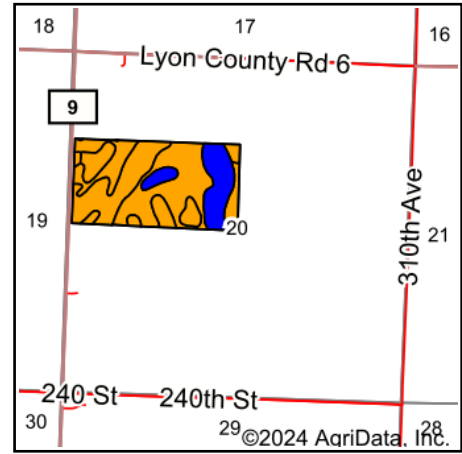

State: **Minnesota**
 County: **Lyon**
 Location: **20-111N-40W**
 Township: **Clifton**
 Acres: **78.5**
 Date: **5/22/2024**



Maps Provided By:



Area Symbol: MN083, Soil Area Version: 20

Code	Soil Description	Acres	Percent of field	Non-Irr Class Legend	Non-Irr Class *c	Productivity Index
86	Canisteo clay loam, 0 to 2 percent slopes	36.37	46.3%		IIw	93
421B	Amiret loam, 2 to 6 percent slopes	17.35	22.1%		Ile	98
L84A	Glencoe clay loam, 0 to 1 percent slopes	13.72	17.5%		IIIw	86
423	Seaforth loam, 1 to 3 percent slopes	9.84	12.5%		IIs	95
421B2	Amiret-Swanlake loams, 2 to 6 percent slopes	1.22	1.6%		Ile	92
Weighted Average					2.17	93.1

*c: Using Capabilities Class Dominant Condition Aggregation Method