

Soils Map

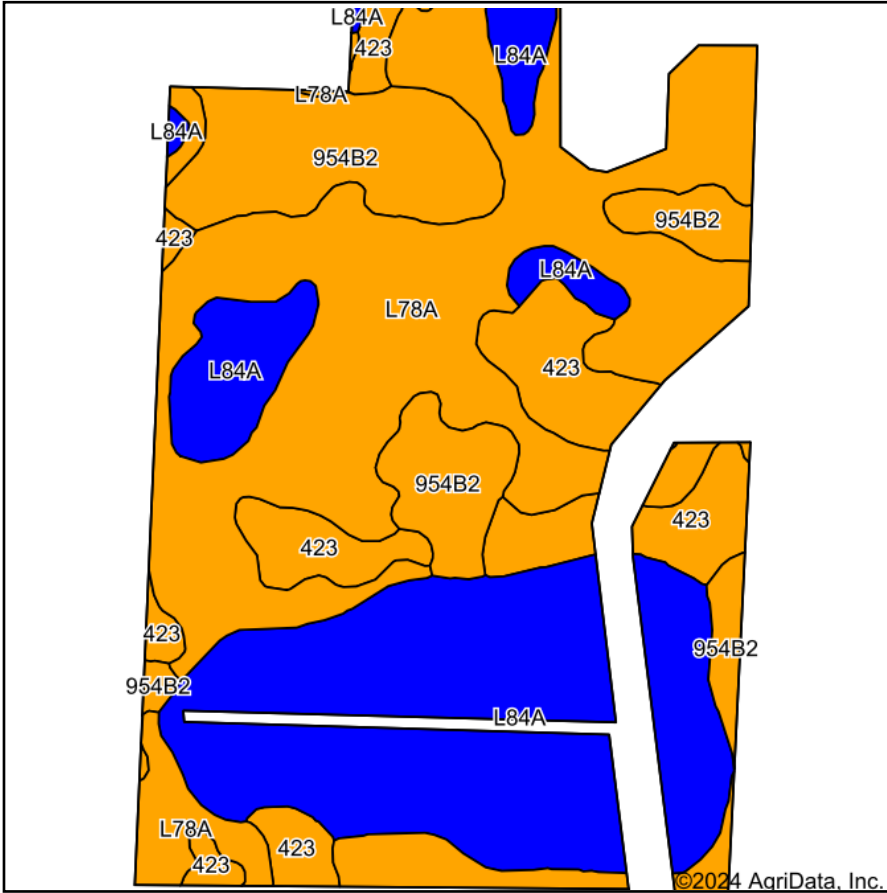

Soils data provided by USDA and NRCS.

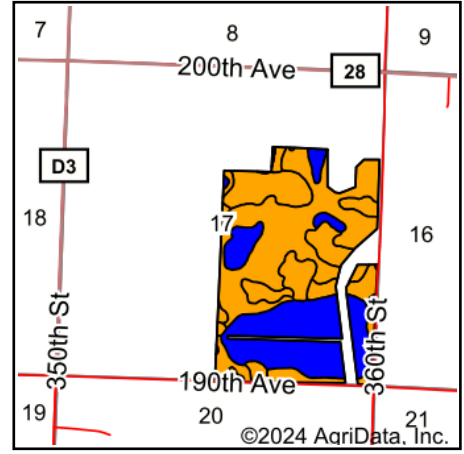

State: **Minnesota**
 County: **Yellow Medicine**
 Location: **17-114N-42W**
 Township: **Swede Prairie**
 Acres: **206.41**
 Date: **2/19/2024**



Maps Provided By:



Area Symbol: MN173, Soil Area Version: 18

Code	Soil Description	Acres	Percent of field	Non-Irr Class Legend	Non-Irr Class *c	Productivity Index
L78A	Canisteo clay loam, 0 to 2 percent slopes	83.31	40.4%		IIw	93
L84A	Glencoe clay loam, 0 to 1 percent slopes	66.80	32.4%		IIIw	86
954B2	Amiret-Swanlake loams, 2 to 6 percent slopes	30.51	14.8%		Ile	92
423	Seaforth loam, 1 to 3 percent slopes	25.79	12.5%		IIs	95
Weighted Average					2.32	90.8

*c: Using Capabilities Class Dominant Condition Aggregation Method