

Soils Map

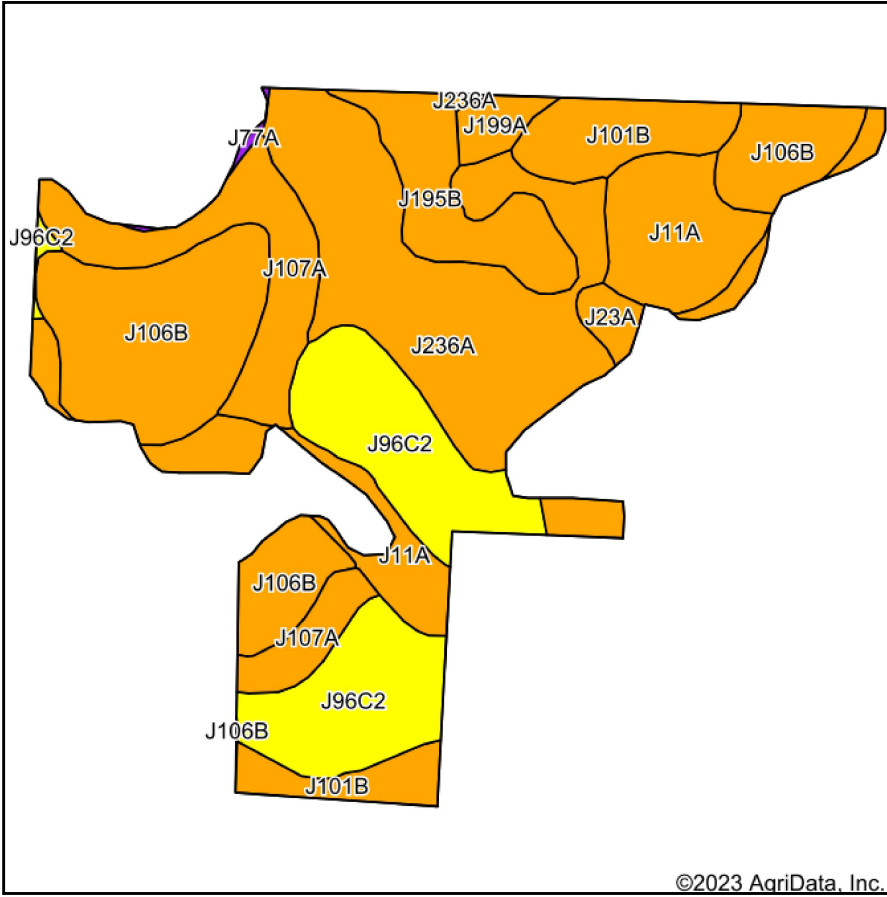

©2023 AgriData, Inc.

Soils data provided by USDA and NRCS.

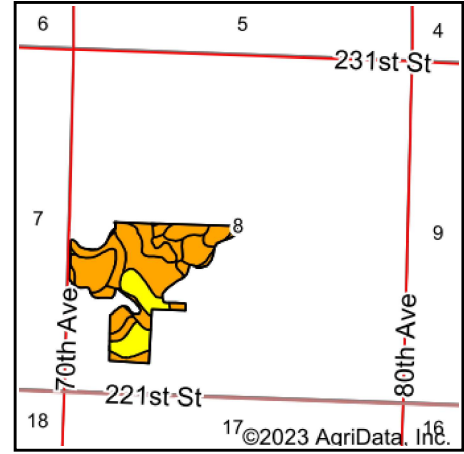

State: **Minnesota**
 County: **Murray**
 Location: **8-108N-42W**
 Township: **Skandia**
 Acres: **61.75**
 Date: **10/27/2023**



Area Symbol: MN101, Soil Area Version: 23

Code	Soil Description	Acres	Percent of field	Non-Irr Class Legend	Non-Irr Class *c	Productivity Index
J236A	Highpoint Lake silty clay, 0 to 2 percent slopes	13.39	21.7%		Ils	90
J106B	Barnes, occasional saturation-Buse-Svea complex, 1 to 6 percent slopes	12.09	19.6%		Ile	88
J96C2	Barnes-Buse complex, 6 to 12 percent slopes, moderately eroded	10.69	17.3%		IVe	80
J11A	Vallers clay loam, 0 to 2 percent slopes	7.46	12.1%		Ilw	90
J107A	Lakepark-Roliss-Parnell, depressional, complex, 0 to 3 percent slopes	6.44	10.4%		Ilw	93
J101B	Hokans-Svea complex, 1 to 4 percent slopes	4.53	7.3%		Ile	98
J195B	Poinsett-Waubay silty clay loams, 1 to 6 percent slopes	4.02	6.5%		Ile	93
J23A	Lamoure silty clay loam, 0 to 2 percent slopes, occasionally flooded	2.09	3.4%		Ilw	78
J199A	Fulda silty clay, 0 to 2 percent slopes	0.92	1.5%		Ilw	86
J77A	Lamoure silty clay loam, 0 to 2 percent slopes, frequently flooded	0.12	0.2%		Vw	20
Weighted Average					2.35	88.4

*c: Using Capabilities Class Dominant Condition Aggregation Method
 Soils data provided by USDA and NRCS.