

# Soils Map

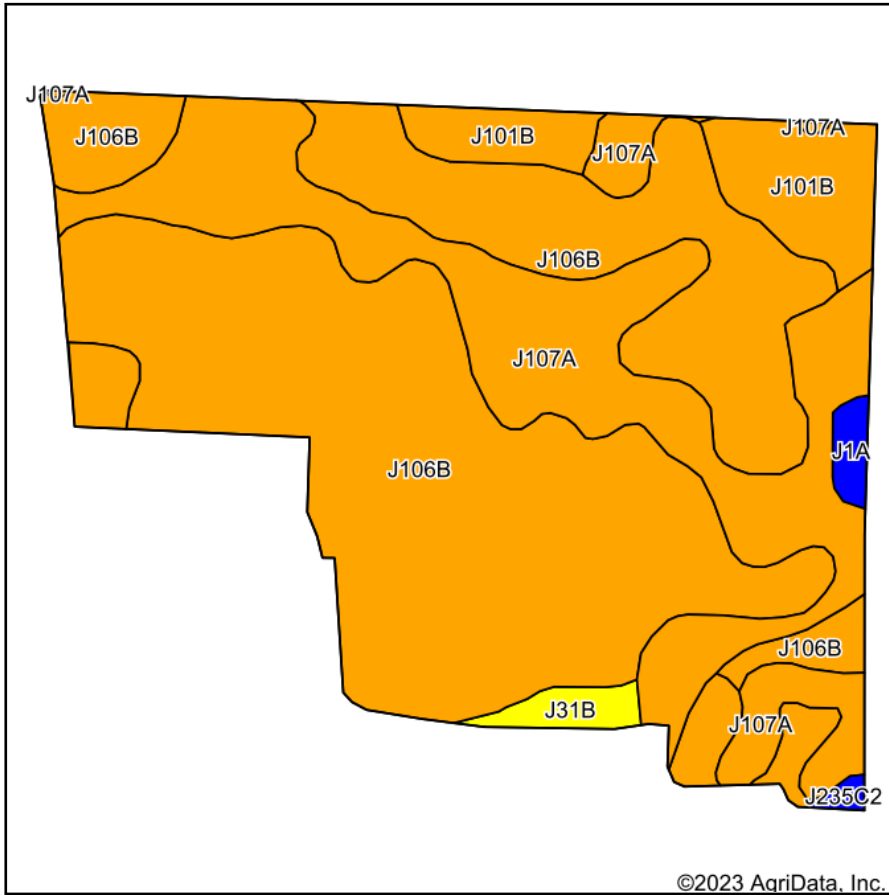

Soils data provided by USDA and NRCS.

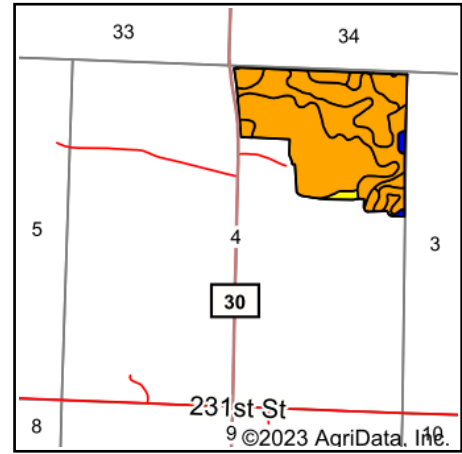

State: **Minnesota**  
 County: **Murray**  
 Location: **4-108N-41W**  
 Township: **Lake Sarah**  
 Acres: **104**  
 Date: **5/17/2023**



Maps Provided By:



Area Symbol: MN101, Soil Area Version: 22

Code	Soil Description	Acres	Percent of field	Non-Irr Class Legend	Non-Irr Class *c	Productivity Index
J106B	Barnes-Buse-Svea complex, 1 to 6 percent slopes	63.12	60.7%		Ile	88
J107A	Lakepark-Roliss-Parnell, depressional, complex, 0 to 3 percent slopes	28.99	27.9%		IIw	93
J101B	Hokans-Svea complex, 1 to 4 percent slopes	7.25	7.0%		Ile	98
J232B	Barnes-Buse-Arvilla complex, 2 to 6 percent slopes	2.17	2.1%		Ile	74
J31B	Arvilla-Sandberg complex, 2 to 6 percent slopes	1.34	1.3%		IVs	39
J1A	Parnell silty clay loam, depressional, 0 to 1 percent slopes	0.83	0.8%		IIIw	86
J235C2	Buse-Barnes-Arvilla complex, 6 to 12 percent slopes, moderately eroded	0.30	0.3%		IIIe	64
<b>Weighted Average</b>					<b>2.04</b>	<b>89.1</b>

\*c: Using Capabilities Class Dominant Condition Aggregation Method  
 Soils data provided by USDA and NRCS.