

# Soils Map

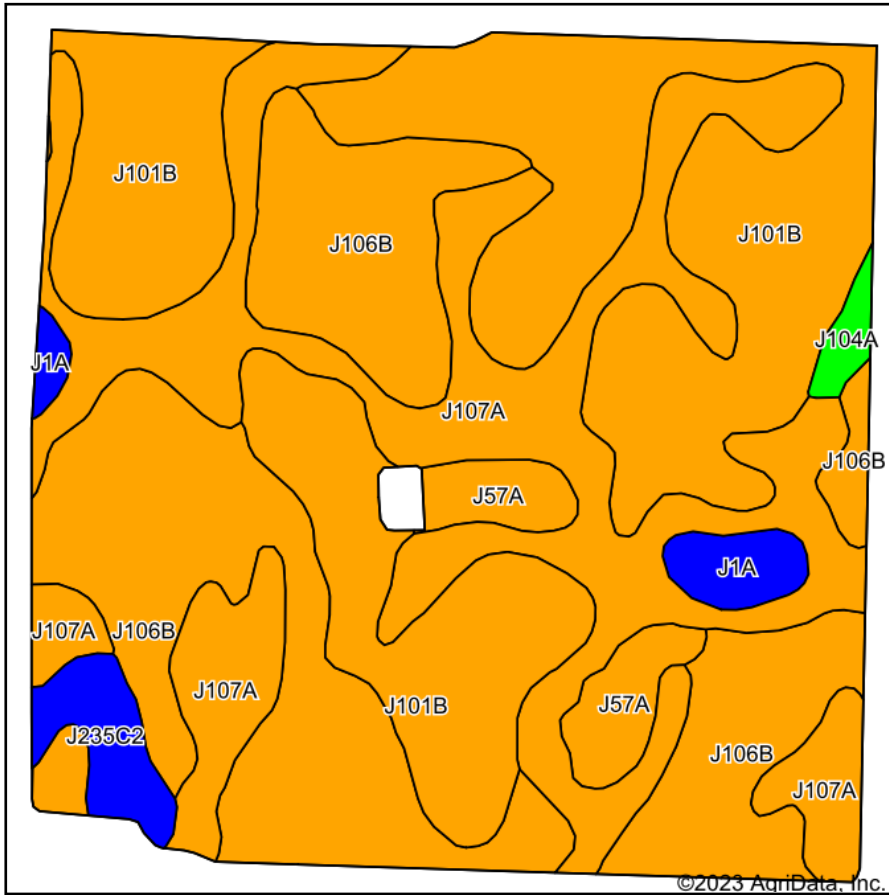

Soils data provided by USDA and NRCS.

©2023 AgriData, Inc.

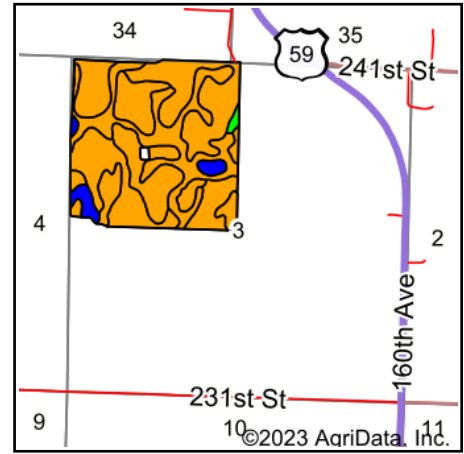

State: **Minnesota**  
 County: **Murray**  
 Location: **3-108N-41W**  
 Township: **Lake Sarah**  
 Acres: **159.5**  
 Date: **5/17/2023**



Area Symbol: MN101, Soil Area Version: 22

Code	Soil Description	Acres	Percent of field	Non-Irr Class Legend	Non-Irr Class *c	Productivity Index
J101B	Hokans-Svea complex, 1 to 4 percent slopes	57.17	35.8%		Ile	98
J107A	Lakepark-Roliss-Parnell, depressionnal, complex, 0 to 3 percent slopes	45.19	28.3%		IIw	93
J106B	Barnes-Buse-Svea complex, 1 to 6 percent slopes	44.79	28.1%		Ile	88
J57A	Balaton loam, 1 to 3 percent slopes	5.13	3.2%		IIs	96
J235C2	Buse-Barnes-Arvilla complex, 6 to 12 percent slopes, moderately eroded	3.33	2.1%		IIIe	64
J1A	Parnell silty clay loam, depressionnal, 0 to 1 percent slopes	2.81	1.8%		IIIw	86
J104A	Svea loam, 1 to 3 percent slopes	1.08	0.7%		Ie	99
<b>Weighted Average</b>					<b>2.03</b>	<b>92.8</b>

\*c: Using Capabilities Class Dominant Condition Aggregation Method  
 Soils data provided by USDA and NRCS.