

Soils Map

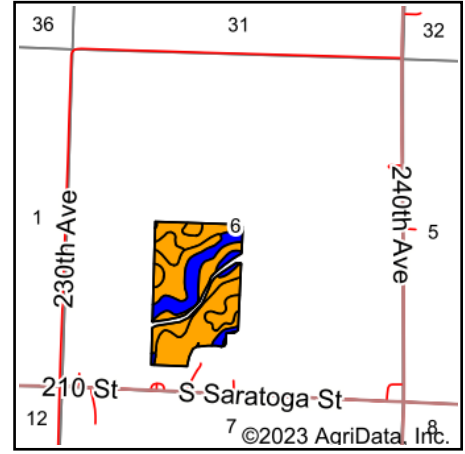

State: **Minnesota**
 County: **Lyon**
 Location: **6-110N-41W**
 Township: **Sodus**
 Acres: **61.04**
 Date: **3/8/2023**

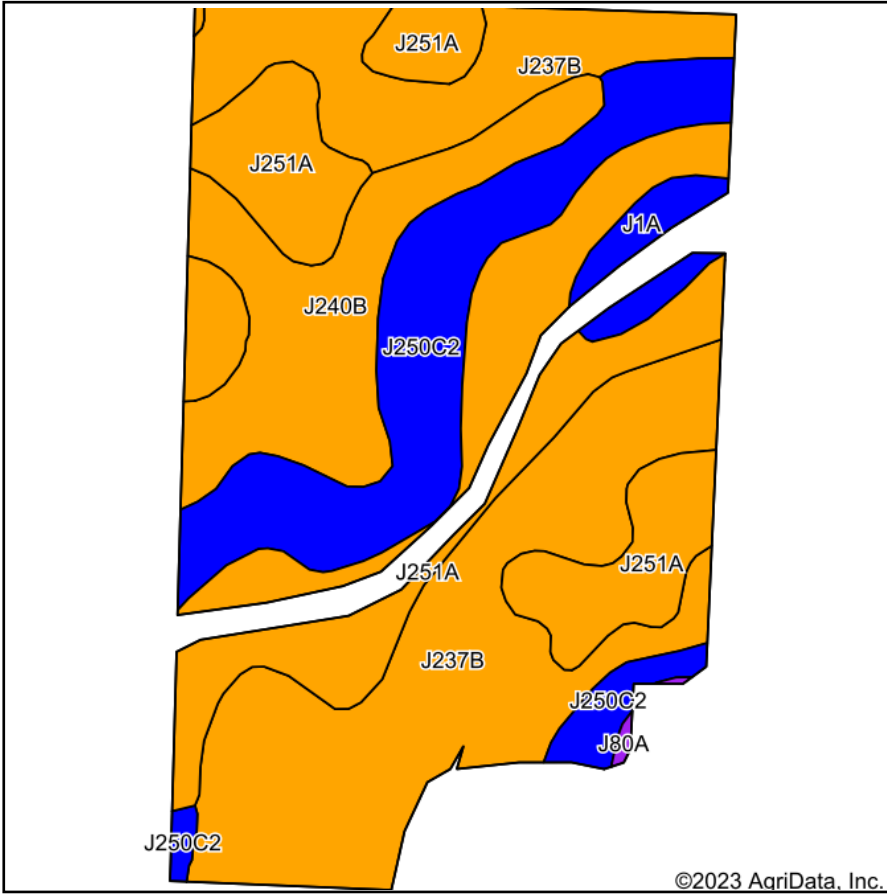

Soils data provided by USDA and NRCS.

©2023 AgriData, Inc.

Area Symbol: MN083, Soil Area Version: 19

Code	Soil Description	Acres	Percent of field	Non-Irr Class Legend	Non-Irr Class *c	Productivity Index
J237B	Brensall-Tress complex 1 to 4 percent slopes	22.12	36.2%		Ile	95
J251A	Parnell silty clay loam, firm till, 0 to 2 percent slopes	18.28	29.9%		IIlw	94
J250C2	Forman-Buse complex, 6 to 12 percent slopes, moderately eroded	10.67	17.5%		IIIle	81
J240B	Forman-Aastad complex, 3 to 6 percent slopes	8.34	13.7%		Ile	94
J1A	Parnell silty clay loam, depressional, 0 to 1 percent slopes	1.52	2.5%		IIIlw	86
J80A	Lamoure-La Prairie complex, channeled, 0 to 2 percent slopes, frequently flooded	0.11	0.2%		Vw	20
Weighted Average					2.21	91.8

*c: Using Capabilities Class Dominant Condition Aggregation Method
 Soils data provided by USDA and NRCS.