

Soils Map

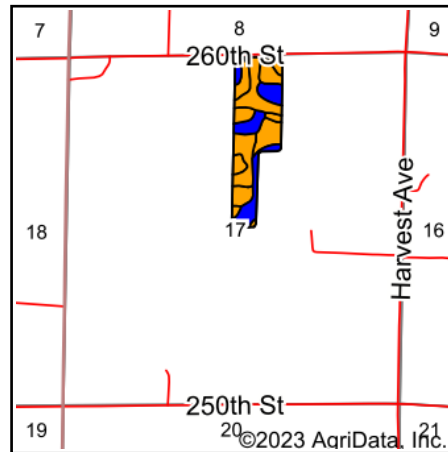

State: **Minnesota**
 County: **Redwood**
 Location: **17-111N-37W**
 Township: **Vail**
 Acres: **34.68**
 Date: **1/17/2023**

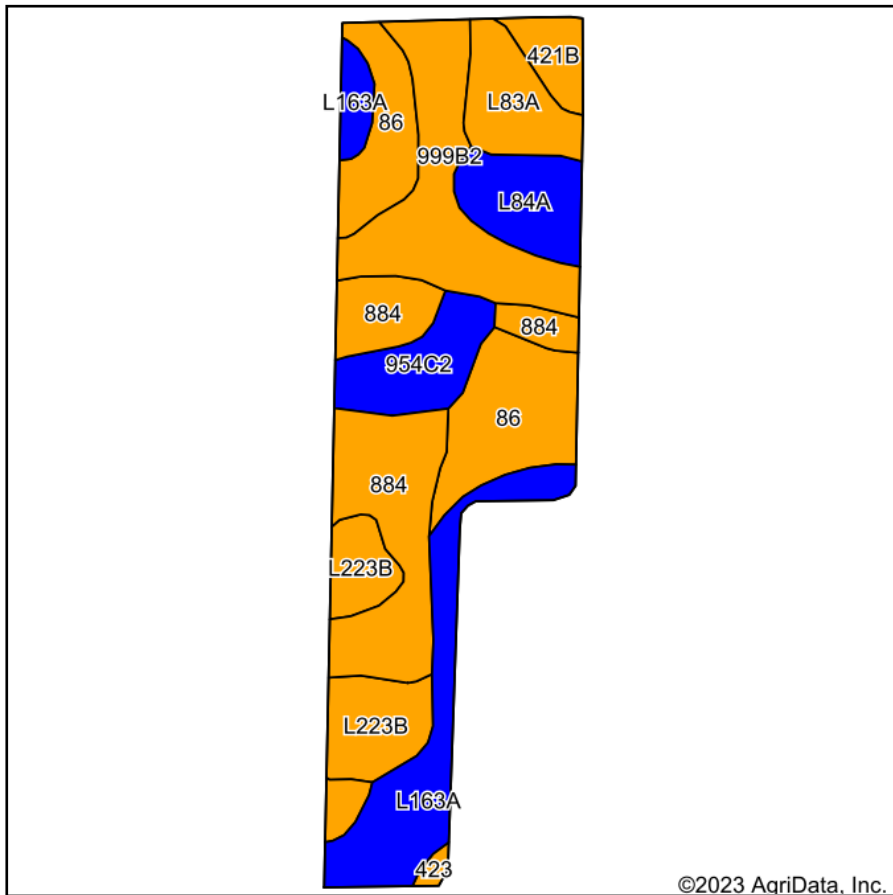

Soils data provided by USDA and NRCS.

©2023 AgriData, Inc.

Area Symbol: MN127, Soil Area Version: 21

Code	Soil Description	Acres	Percent of field	Non-Irr Class Legend	Non-Irr Class *c	Productivity Index
884	Webster-Delft complex, 0 to 2 percent slopes	6.70	19.3%		IIw	94
86	Canisteo clay loam, 0 to 2 percent slopes	6.25	18.0%		IIw	93
999B2	Ves-Estherville-Storden complex, 3 to 6 percent slopes, eroded	5.31	15.3%		Ile	69
L163A	Okoboji silty clay loam, 0 to 1 percent slopes	4.98	14.4%		IIIw	86
L223B	Amiret-Swanlake loams, 2 to 6 percent slopes	3.21	9.3%		Ile	92
954C2	Storden-Ves complex, 6 to 10 percent slopes, moderately eroded	2.39	6.9%		IIIe	77
L84A	Glencoe clay loam, 0 to 1 percent slopes	2.36	6.8%		IIIw	86
L83A	Webster clay loam, 0 to 2 percent slopes	2.26	6.5%		IIw	93
421B	Amiret loam, 2 to 6 percent slopes	1.04	3.0%		Ile	98
423	Seaforth loam, 1 to 3 percent slopes	0.18	0.5%		IIs	95
Weighted Average					2.28	87

*c: Using Capabilities Class Dominant Condition Aggregation Method
 Soils data provided by USDA and NRCS.