

Soils Map

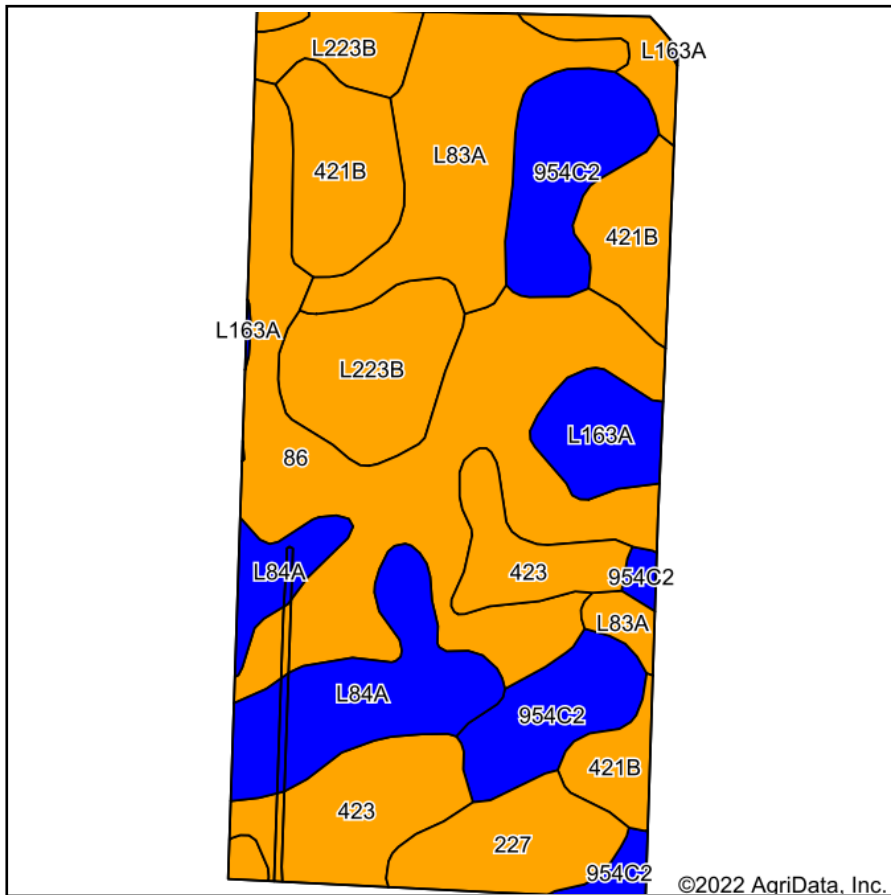

Soils data provided by USDA and NRCS.

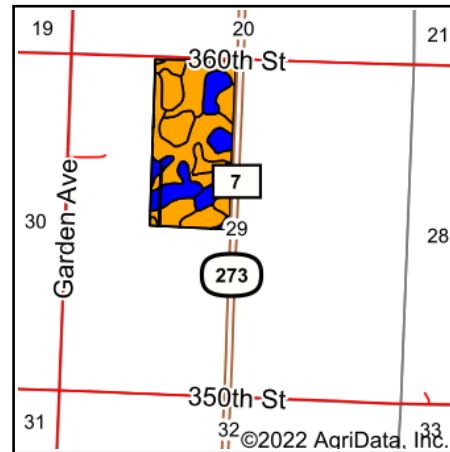

State: **Minnesota**
 County: **Redwood**
 Location: **29-113N-37W**
 Township: **Kintire**
 Acres: **76.42**
 Date: **9/28/2022**



Maps Provided By:



Area Symbol: MN127, Soil Area Version: 20

Code	Soil Description	Acres	Percent of field	Non-Irr Class Legend	Non-Irr Class *c	Productivity Index
86	Canisteo clay loam, 0 to 2 percent slopes	21.09	27.6%		IIw	93
954C2	Storden-Ves complex, 6 to 10 percent slopes, moderately eroded	9.05	11.8%		IIIe	77
L83A	Webster clay loam, 0 to 2 percent slopes	8.83	11.6%		IIw	93
421B	Amiret loam, 2 to 6 percent slopes	8.48	11.1%		Ile	98
L84A	Glencoe clay loam, 0 to 1 percent slopes	7.59	9.9%		IIIw	86
423	Seaforth loam, 1 to 3 percent slopes	7.57	9.9%		IIs	95
L223B	Amiret-Swanlake loams, 2 to 6 percent slopes	7.15	9.4%		Ile	92
227	Lemond loam, 0 to 2 percent slopes	3.96	5.2%		IIw	69
L163A	Okoboji silty clay loam, 0 to 1 percent slopes	2.70	3.5%		IIIw	86
Weighted Average					2.25	89.6

*c: Using Capabilities Class Dominant Condition Aggregation Method
 Soils data provided by USDA and NRCS.