

Soils Map

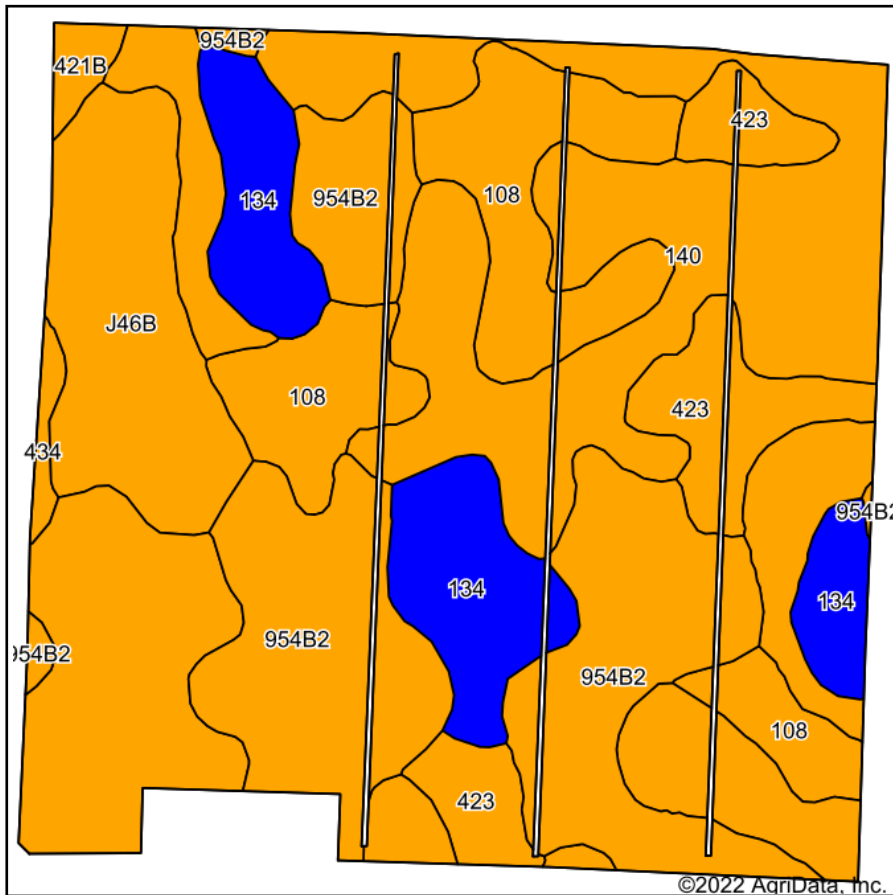

Soils data provided by USDA and NRCS.

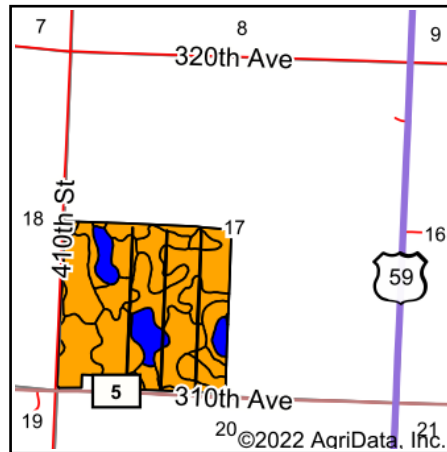

State: **Minnesota**
 County: **Yellow Medicine**
 Location: **17-116N-41W**
 Township: **Lisbon**
 Acres: **150.5**
 Date: **9/1/2022**



Maps Provided By:



Area Symbol: MN173, Soil Area Version: 16

Code	Soil Description	Acres	Percent of field	Non-Irr Class Legend	Non-Irr Class *c	Productivity Index
140	Spicer silty clay loam, 0 to 2 percent slopes	58.65	39.0%		IIw	91
954B2	Amiret-Swanlake loams, 2 to 6 percent slopes	32.75	21.8%		Ile	92
108	McIntosh silt loam, 1 to 3 percent slopes	18.30	12.2%		IIs	90
134	Okoboji silty clay loam, 0 to 1 percent slopes	14.97	9.9%		IIIw	86
J46B	Byrne silt loam, 1 to 6 percent slopes	13.67	9.1%		Ile	90
423	Seaforth loam, 1 to 3 percent slopes	10.13	6.7%		IIs	95
421B	Amiret loam, 2 to 6 percent slopes	1.15	0.8%		Ile	98
434	Perella silty clay loam	0.88	0.6%		IIw	95
Weighted Average					2.10	90.9

*c: Using Capabilities Class Dominant Condition Aggregation Method
 Soils data provided by USDA and NRCS.