

Soils Map

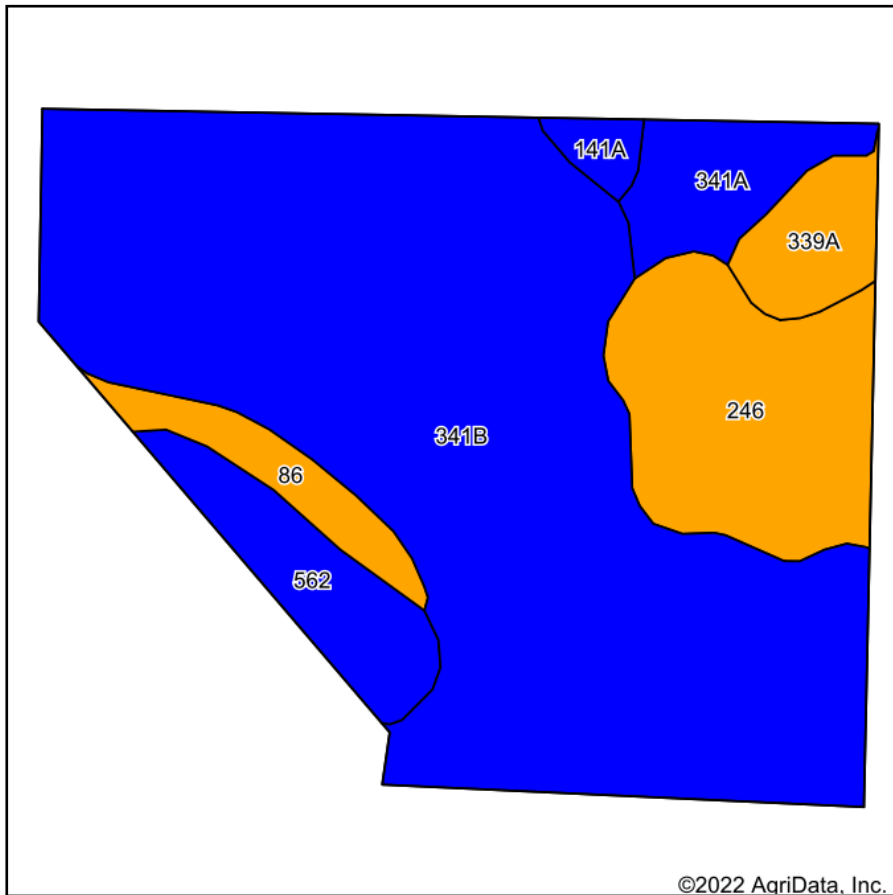

Soils data provided by USDA and NRCS.

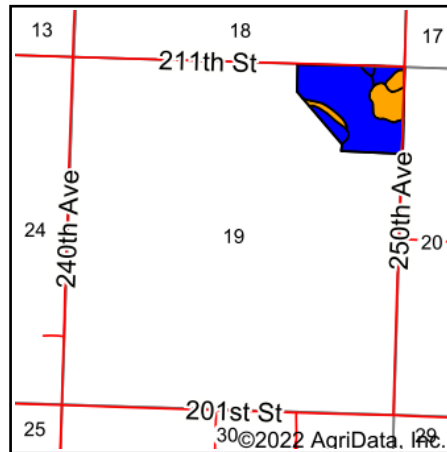

State: **Minnesota**
 County: **Murray**
 Location: **19-108N-39W**
 Township: **Holly**
 Acres: **40.93**
 Date: **8/19/2022**



Area Symbol: MN101, Soil Area Version: 21

Code	Soil Description	Acres	Percent of field	Non-Irr Class Legend	Non-Irr Class *c	Productivity Index
341B	Estherville sandy loam, 2 to 6 percent slopes	27.55	67.3%		III s	44
246	Marysland loam	5.53	13.5%		II w	65
562	Knoke silty clay loam, 0 to 1 percent slopes	2.46	6.0%		III w	78
341A	Arvilla sandy loam, 0 to 2 percent slopes	1.99	4.9%		III s	44
339A	Fordville loam, 0 to 2 percent slopes	1.50	3.7%		II s	64
86	Canisteo clay loam, 0 to 2 percent slopes	1.43	3.5%		II w	93
141A	Egeland sandy loam, 0 to 2 percent slopes	0.47	1.1%		III s	74
Weighted Average					2.79	51.7

*c: Using Capabilities Class Dominant Condition Aggregation Method
 Soils data provided by USDA and NRCS.