

Soils Map

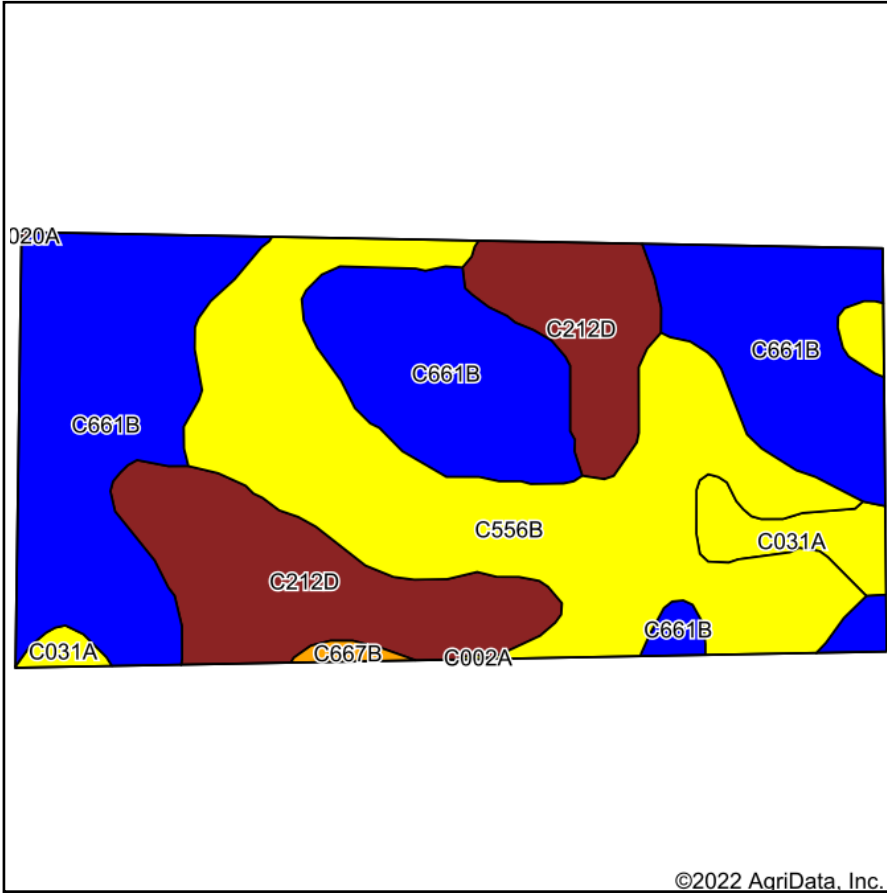

Soils data provided by USDA and NRCS.

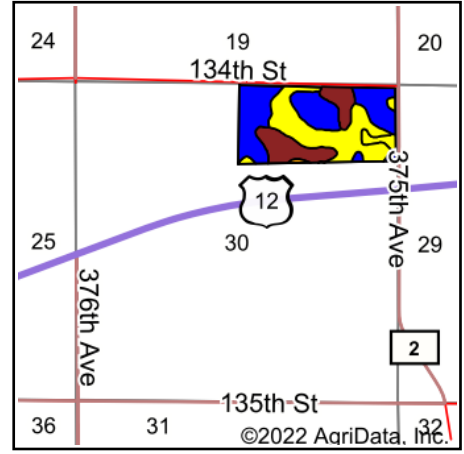

State: **South Dakota**
 County: **Brown**
 Location: **30-123N-65W**
 Township: **Mercier**
 Acres: **75.37**
 Date: **7/13/2022**



Maps Provided By:



Area Symbol: SD013, Soil Area Version: 27

Code	Soil Description	Acres	Percent of field	Non-Irr Class Legend	Non-Irr Class *c	Productivity Index
C661B	Niobell-Noonan loams, 3 to 6 percent slopes	32.05	42.5%		IIIe	60
C556B	Noonan-Miranda loams, 0 to 6 percent slopes	24.90	33.0%		IVs	42
C212D	Williams-Zahl loams, 6 to 15 percent slopes	15.24	20.2%		VIe	53
C031A	Rimlap-Heil silt loams, 0 to 1 percent slopes	2.82	3.7%		IVw	36
C667B	Williams-Niobell loams, 3 to 6 percent slopes	0.36	0.5%		Ile	77
Weighted Average					3.97	51.8

*c: Using Capabilities Class Dominant Condition Aggregation Method
 Soils data provided by USDA and NRCS.