

Soils Map

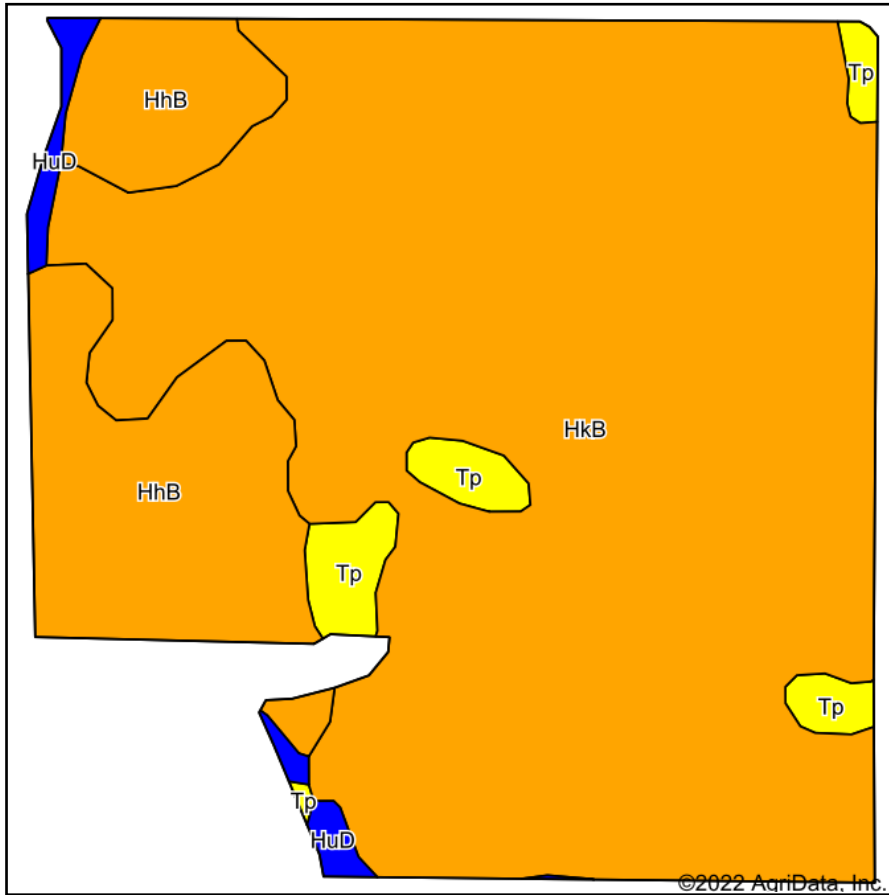

Soils data provided by USDA and NRCS.

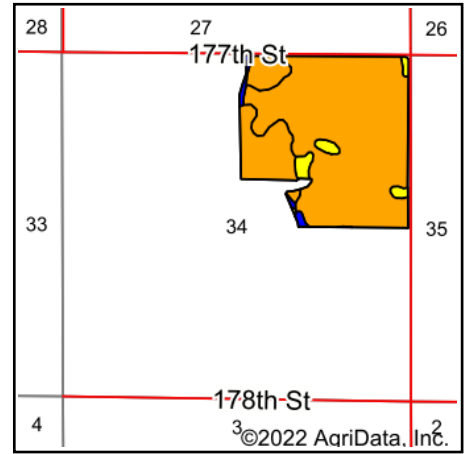

State: **South Dakota**
 County: **Hand**
 Location: **34-116N-66W**
 Township: **Plato**
 Acres: **138.44**
 Date: **7/25/2022**



Maps Provided By:



© AgriData, Inc. 2021

www.AgriDataInc.com



Area Symbol: SD059, Soil Area Version: 23

Code	Soil Description	Acres	Percent of field	Non-Irr Class Legend	Non-Irr Class *c	Productivity Index
HkB	Houdek-Prosper loams, 1 to 6 percent slopes	108.40	78.3%		Ile	84
HhB	Houdek loam, 2 to 6 percent slopes	23.12	16.7%		Ile	81
Tp	Tetonka silt loam, 0 to 1 percent slopes	4.96	3.6%		IVw	56
HuD	Houdek-Ethan loams, 6 to 9 percent slopes	1.96	1.4%		IIIe	58
Weighted Average					2.09	82.1

*c: Using Capabilities Class Dominant Condition Aggregation Method
 Soils data provided by USDA and NRCS.