

Soils Map

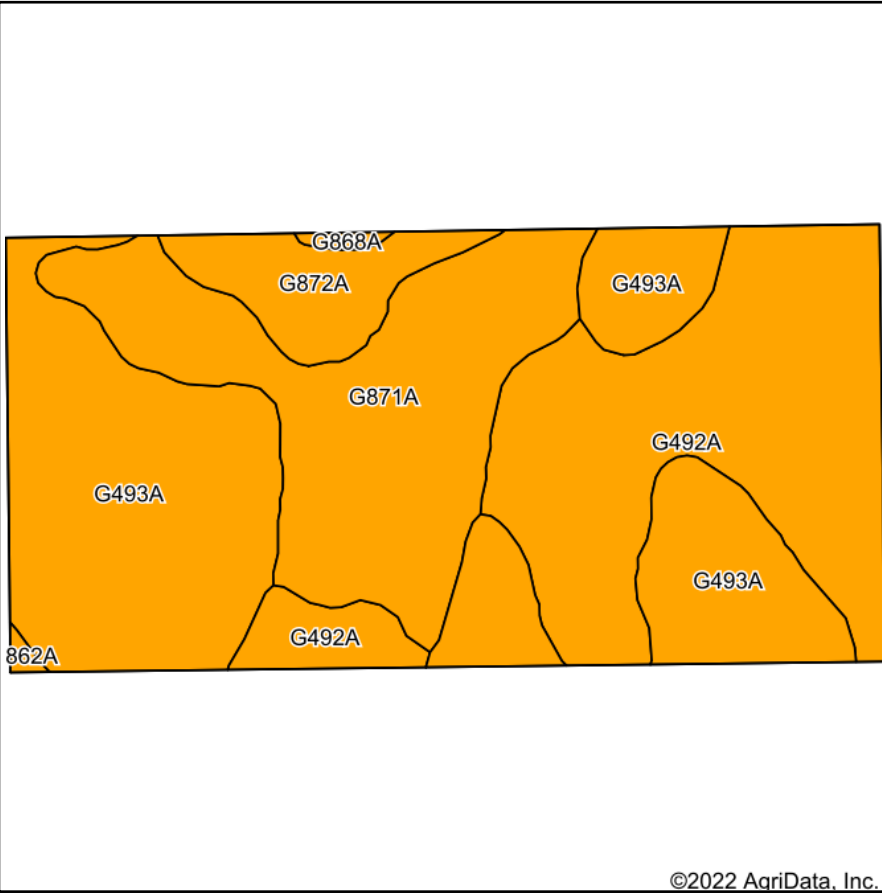

Soils data provided by USDA and NRCS.

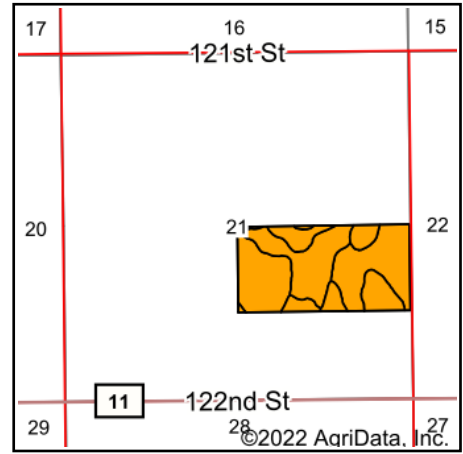

State: **South Dakota**
 County: **Brown**
 Location: **21-125N-60W**
 Township: **Claremont**
 Acres: **78.04**
 Date: **7/13/2022**



Maps Provided By:



Area Symbol: SD013, Soil Area Version: 27

Code	Soil Description	Acres	Percent of field	Non-Irr Class Legend	Non-Irr Class *c	Productivity Index
G493A	Eckman-Gardena very fine sandy loams, 0 to 2 percent slopes	29.40	37.7%		Ile	90
G492A	Gardena very fine sandy loam, 0 to 2 percent slopes	24.48	31.4%		Ile	92
G871A	Beotia silt loam, 0 to 2 percent slopes	19.13	24.5%		Ilc	98
G872A	Beotia-Rondell silt loams, 0 to 2 percent slopes	4.56	5.8%		Ilc	91
G868A	Winship-Tonka silt loams, 0 to 1 percent slopes	0.27	0.3%		Ilw	71
G862A	Harmony-Beotia silt loams, 0 to 2 percent slopes	0.20	0.3%		Ils	92
Weighted Average					2.00	92.6

*c: Using Capabilities Class Dominant Condition Aggregation Method
 Soils data provided by USDA and NRCS.