

# Soils Map

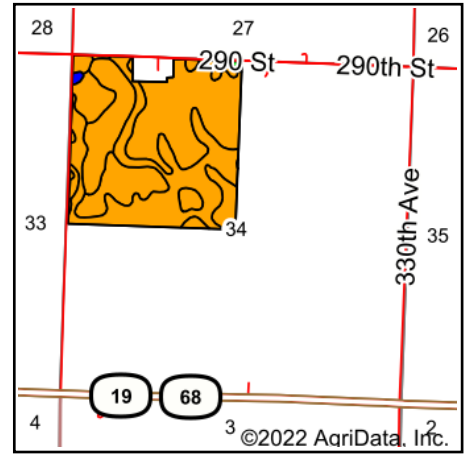

State: **Minnesota**  
 County: **Lyon**  
 Location: **34-112N-40W**  
 Township: **Stanley**  
 Acres: **154.34**  
 Date: **8/5/2022**

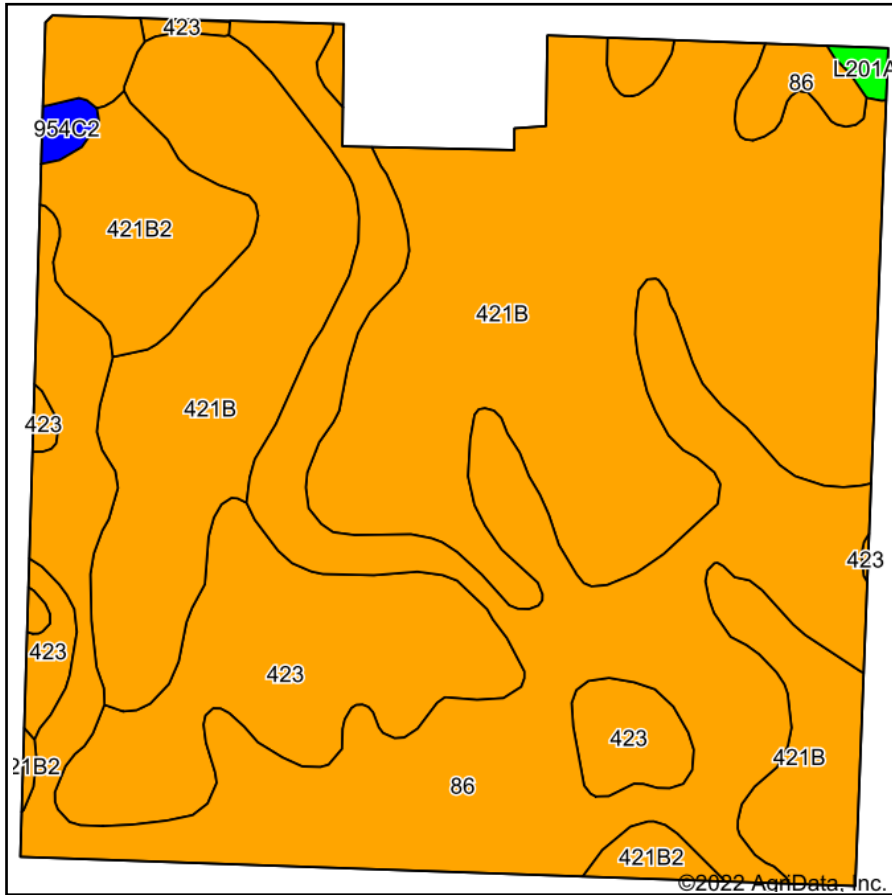

Maps Provided By:



Soils data provided by USDA and NRCS.

Area Symbol: MN083, Soil Area Version: 18						
Code	Soil Description	Acres	Percent of field	Non-Irr Class Legend	Non-Irr Class *c	Productivity Index
421B	Amiret loam, 2 to 6 percent slopes	72.37	46.9%		Ile	98
86	Canisteo clay loam, 0 to 2 percent slopes	52.17	33.8%		IIw	93
423	Seaforth loam, 1 to 3 percent slopes	19.79	12.8%		IIIs	95
421B2	Amiret-Swanlake loams, 2 to 6 percent slopes	8.92	5.8%		Ile	92
954C2	Storden-Ves complex, 6 to 10 percent slopes, moderately eroded	0.62	0.4%		IIIe	77
L201A	Normania loam, 1 to 3 percent slopes	0.47	0.3%		Ie	99
<b>Weighted Average</b>					<b>2.00</b>	<b>95.5</b>

\*c: Using Capabilities Class Dominant Condition Aggregation Method  
 Soils data provided by USDA and NRCS.