

Soils Map

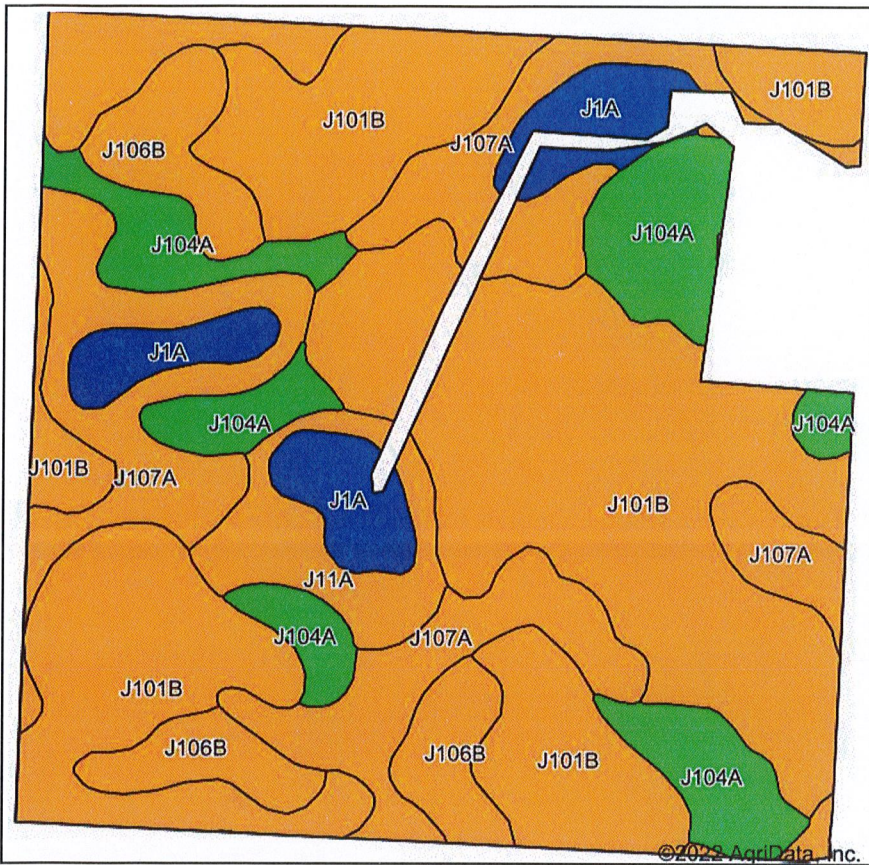

Soils data provided by USDA and NRCS.

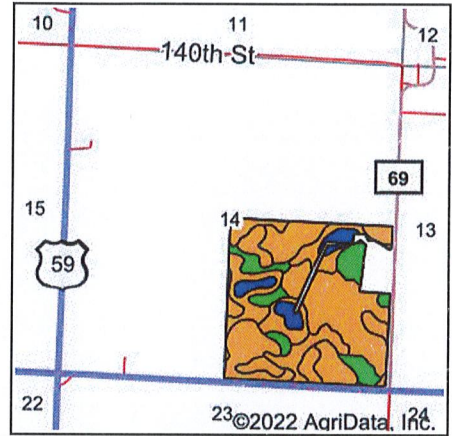

State: **Minnesota**
 County: **Lyon**
 Location: **14-109N-41W**
 Township: **Custer**
 Acres: **142.57**
 Date: **5/16/2022**



Area Symbol: MN083, Soil Area Version: 18

Code	Soil Description	Acres	Percent of field	Non-Irr Class Legend	Non-Irr Class *c	Productivity Index
J101B	Hokans-Svea complex, 1 to 4 percent slopes	68.21	47.8%		Ile	98
J107A	Lakepark-Roliss-Parnell, depressional, complex, 0 to 3 percent slopes	31.81	22.3%		IIw	93
J104A	Svea loam, 1 to 3 percent slopes	17.65	12.4%		Ie	99
J106B	Barnes-Buse-Svea complex, 1 to 6 percent slopes	10.58	7.4%		Ile	88
J1A	Parnell silty clay loam, depressional, 0 to 1 percent slopes	8.60	6.0%		IIIw	86
J11A	Vallers clay loam, 0 to 2 percent slopes	5.72	4.0%		IIw	90
Weighted Average					1.94	95.2

*c: Using Capabilities Class Dominant Condition Aggregation Method
 Soils data provided by USDA and NRCS.