

Soils Map

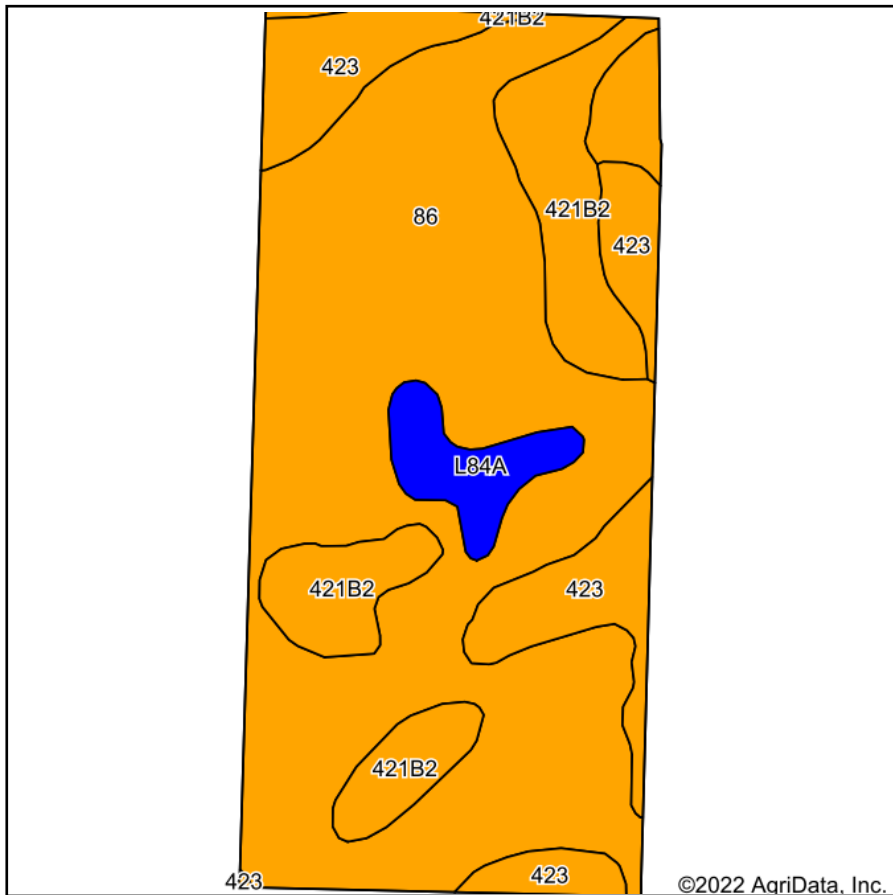

Soils data provided by USDA and NRCS.

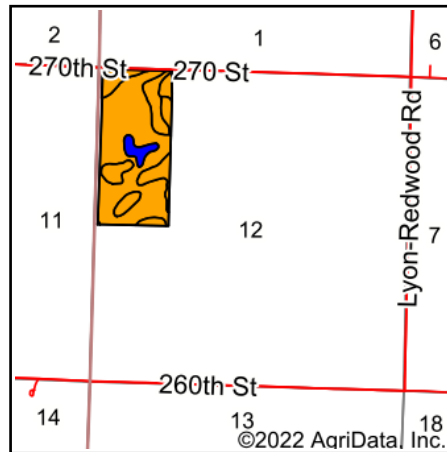

State: **Minnesota**
 County: **Lyon**
 Location: **12-111N-40W**
 Township: **Clifton**
 Acres: **71.52**
 Date: **4/29/2022**



Maps Provided By:



© AgriData, Inc. 2021

www.AgriDataInc.com



Area Symbol: MN083, Soil Area Version: 18

Code	Soil Description	Acres	Percent of field	Non-Irr Class Legend	Non-Irr Class *c	Productivity Index
86	Canisteo clay loam, 0 to 2 percent slopes	47.49	66.4%		IIw	93
421B2	Amiret-Swanlake loams, 2 to 6 percent slopes	10.55	14.8%		IIe	92
423	Seaforth loam, 1 to 3 percent slopes	10.54	14.7%		IIs	95
L84A	Glencoe clay loam, 0 to 1 percent slopes	2.94	4.1%		IIIw	86
Weighted Average					2.04	92.9

*c: Using Capabilities Class Dominant Condition Aggregation Method
 Soils data provided by USDA and NRCS.