

Soils Map

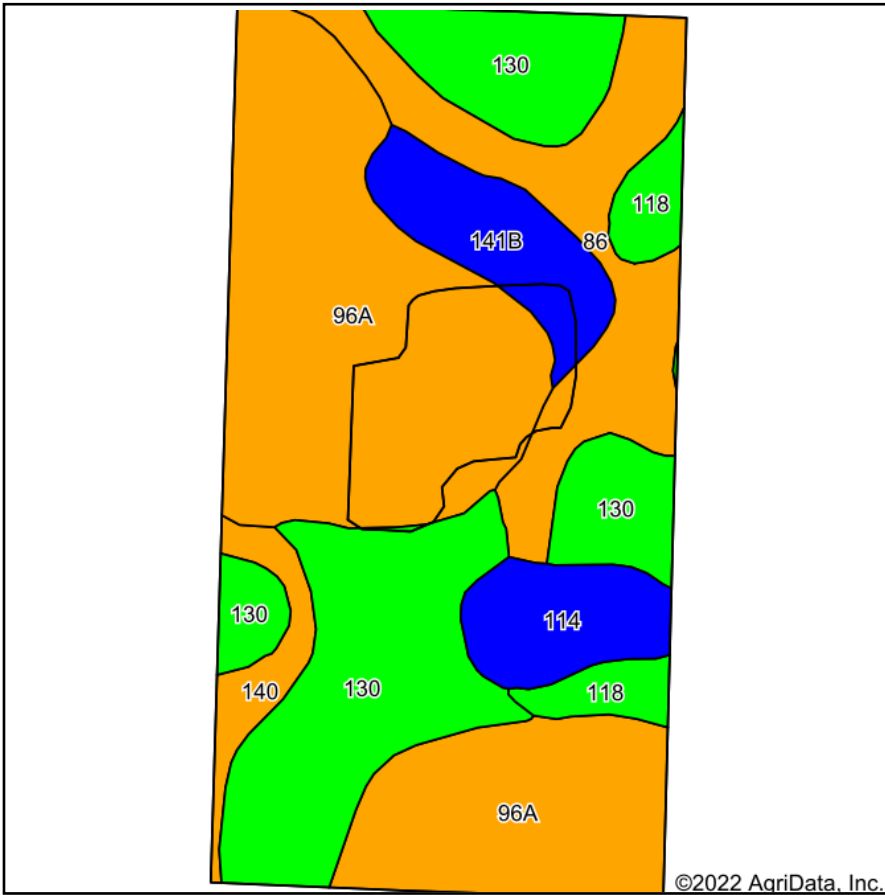

Soils data provided by USDA and NRCS.

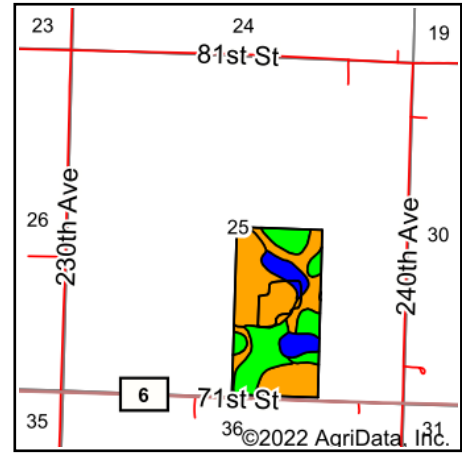

State: **Minnesota**
 County: **Murray**
 Location: **25-106N-40W**
 Township: **Lime Lake**
 Acres: **79.3**
 Date: **3/16/2022**



Maps Provided By:



Area Symbol: MN101, Soil Area Version: 21

| Code | Soil Description | Acres | Percent of field | Non-Irr Class Legend | Non-Irr Class *c | Productivity Index |
|-------------------------|---|-------|------------------|----------------------|------------------|--------------------|
| 96A | Collinwood silty clay loam, 1 to 3 percent slopes | 32.72 | 41.3% | | IIw | 86 |
| 130 | Nicollet clay loam, 1 to 3 percent slopes | 21.31 | 26.9% | | Iw | 99 |
| 86 | Canisteo clay loam, 0 to 2 percent slopes | 10.69 | 13.5% | | IIw | 93 |
| 141B | Egeland sandy loam, 2 to 6 percent slopes | 5.07 | 6.4% | | IIIe | 68 |
| 114 | Glencoe silty clay loam, 0 to 1 percent slopes | 4.26 | 5.4% | | IIIw | 86 |
| 118 | Crippin loam, 1 to 3 percent slopes | 2.88 | 3.6% | | Ie | 100 |
| 140 | Spicer silty clay loam, 0 to 2 percent slopes | 2.37 | 3.0% | | IIw | 91 |
| Weighted Average | | | | | 1.81 | 89.9 |

*c: Using Capabilities Class Dominant Condition Aggregation Method
 Soils data provided by USDA and NRCS.