

Soils Map

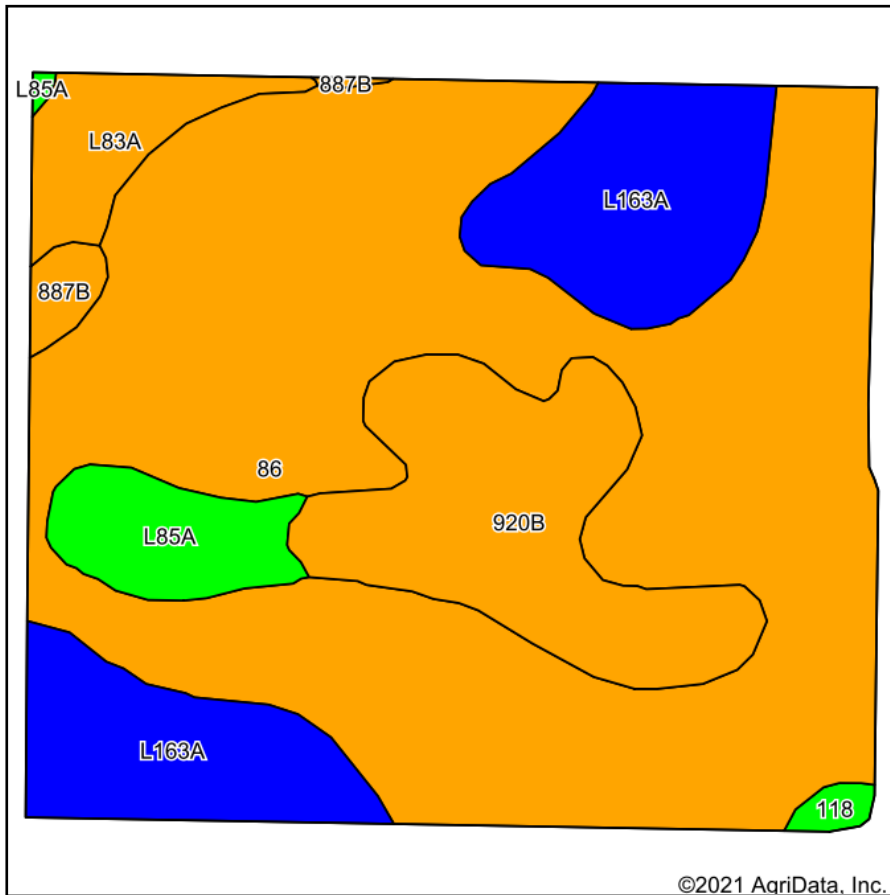

Soils data provided by USDA and NRCS.

©2021 AgriData, Inc.

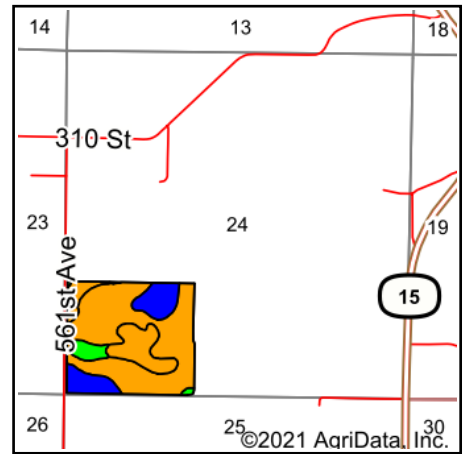

State: **Minnesota**
 County: **Sibley**
 Location: **24-112N-30W**
 Township: **Cornish**
 Acres: **76.99**
 Date: **7/7/2021**



Maps Provided By:



Area Symbol: MN143, Soil Area Version: 17

Code	Soil Description	Acres	Percent of field	Non-Irr Class Legend	Non-Irr Class *c	Productivity Index
86	Canisteo clay loam, 0 to 2 percent slopes	47.82	62.1%		IIw	93
L163A	Okoboji silty clay loam, 0 to 1 percent slopes	12.07	15.7%		IIIw	86
920B	Clarion-Hawick complex, 3 to 6 percent slopes	9.93	12.9%		Ile	71
L85A	Nicollet clay loam, 1 to 3 percent slopes	3.20	4.2%		Iw	99
L83A	Webster clay loam, 0 to 2 percent slopes	2.76	3.6%		IIw	93
887B	Clarion-Swanlake complex, 2 to 6 percent slopes	0.82	1.1%		Ile	92
118	Crippin loam, 1 to 3 percent slopes	0.39	0.5%		Ie	100
Weighted Average						89.3

*c: Using Capabilities Class Dominant Condition Aggregation Method
 Soils data provided by USDA and NRCS.