

Soils Map

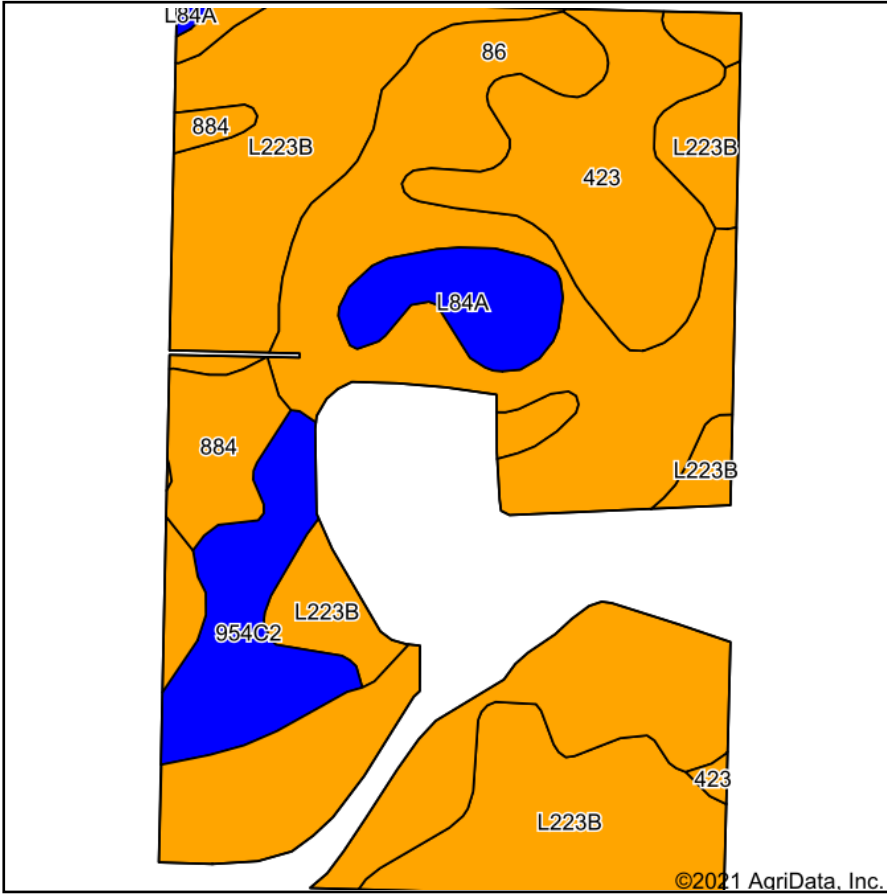

Soils data provided by USDA and NRCS.

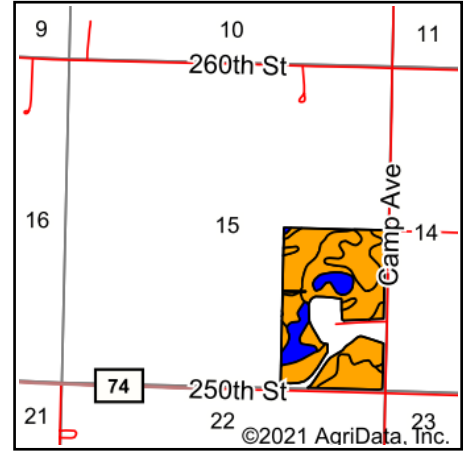

State: **Minnesota**
 County: **Redwood**
 Location: **15-111N-39W**
 Township: **Westline**
 Acres: **82.4**
 Date: **5/18/2021**



Area Symbol: MN127, Soil Area Version: 19

Code	Soil Description	Acres	Percent of field	Non-Irr Class Legend	Non-Irr Class *c	Productivity Index
86	Canisteo clay loam, 0 to 2 percent slopes	33.51	40.7%		IIw	93
L223B	Amiret-Swanlake loams, 2 to 6 percent slopes	25.11	30.5%		Ile	92
423	Seaforth loam, 1 to 3 percent slopes	10.06	12.2%		IIs	95
954C2	Storden-Ves complex, 6 to 10 percent slopes, moderately eroded	6.23	7.6%		IIIe	77
L84A	Glencoe clay loam, 0 to 1 percent slopes	3.79	4.6%		IIIw	86
884	Webster-Delft complex, 0 to 2 percent slopes	3.70	4.5%		IIw	94
Weighted Average						91.5

*c: Using Capabilities Class Dominant Condition Aggregation Method
 Soils data provided by USDA and NRCS.