

Parcel 5 Soils Map

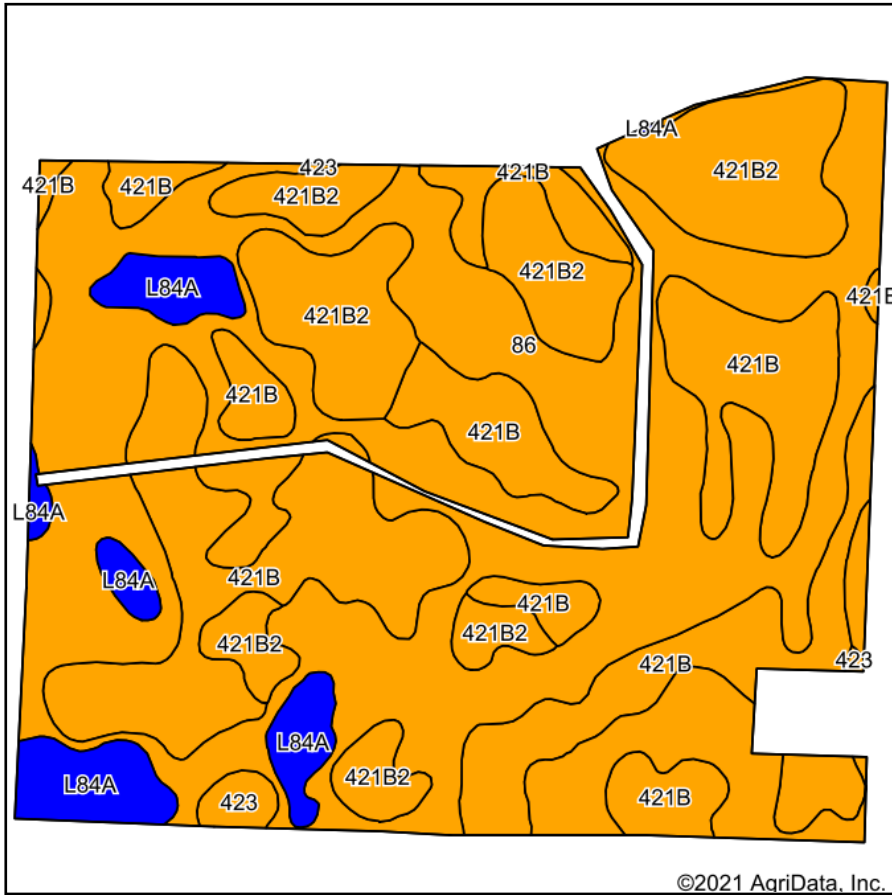

Soils data provided by USDA and NRCS.

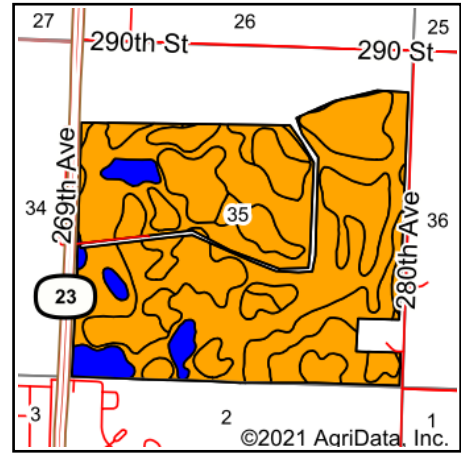

State: **Minnesota**
 County: **Lyon**
 Location: **35-112N-41W**
 Township: **Fairview**
 Acres: **472.94**
 Date: **5/19/2021**



Area Symbol: MN083, Soil Area Version: 17

| Code | Soil Description | Acres | Percent of field | Non-Irr Class Legend | Non-Irr Class *c | Productivity Index |
|-------------------------|--|--------|------------------|----------------------|------------------|--------------------|
| 86 | Canisteo clay loam, 0 to 2 percent slopes | 223.22 | 47.2% | | IIw | 93 |
| 421B | Amiret loam, 2 to 6 percent slopes | 142.87 | 30.2% | | Ile | 98 |
| 421B2 | Amiret-Swanlake loams, 2 to 6 percent slopes | 77.28 | 16.3% | | Ile | 92 |
| L84A | Glencoe clay loam, 0 to 1 percent slopes | 25.75 | 5.4% | | IIIw | 86 |
| 423 | Seaforth loam, 1 to 3 percent slopes | 3.82 | 0.8% | | IIs | 95 |
| Weighted Average | | | | | | 94 |

*c: Using Capabilities Class Dominant Condition Aggregation Method
 Soils data provided by USDA and NRCS.