

# Soils Map

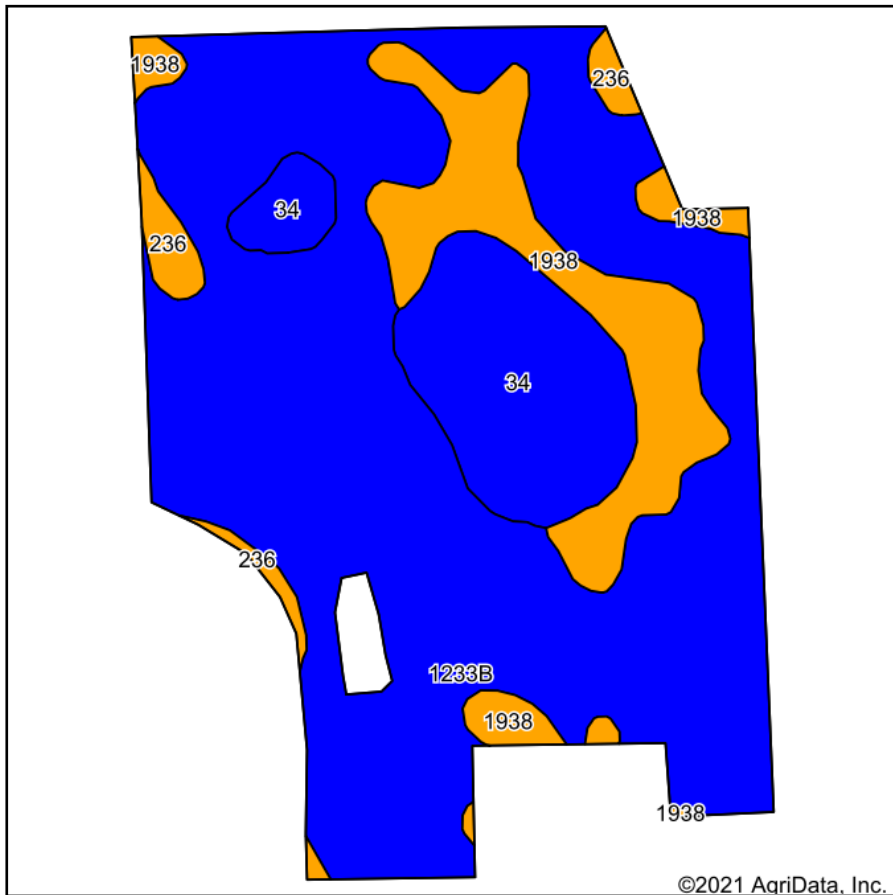

Soils data provided by USDA and NRCS.

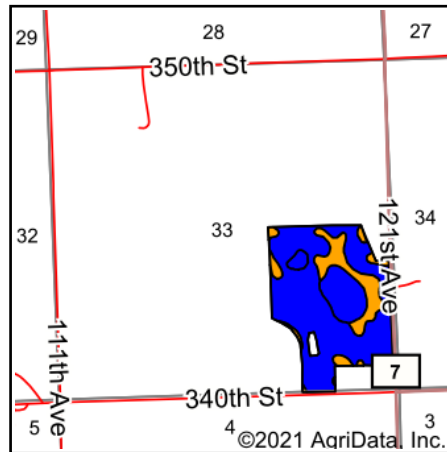

State: **Minnesota**  
 County: **Lac Qui Parle**  
 Location: **33-120N-46W**  
 Township: **Yellow Bank**  
 Acres: **90.11**  
 Date: **4/20/2021**



Area Symbol: MN073, Soil Area Version: 21

Code	Soil Description	Acres	Percent of field	Non-Irr Class Legend	Non-Irr Class *c	Productivity Index
1233B	Esmond-Heimdal-Sisseton complex, 2 to 6 percent slopes	62.80	69.7%		IIIe	84
1938	Lakepark-Parnell, occasionally ponded, complex, 0 to 2 percent slopes	12.98	14.4%		IIw	92
34	Parnell silty clay loam, occasionally ponded, 0 to 1 percent slopes	12.15	13.5%		IIIw	86
236	Vallers clay loam, 0 to 2 percent slopes	2.18	2.4%		IIw	90
<b>Weighted Average</b>						<b>85.6</b>

\*c: Using Capabilities Class Dominant Condition Aggregation Method  
 Soils data provided by USDA and NRCS.