

Soils Map

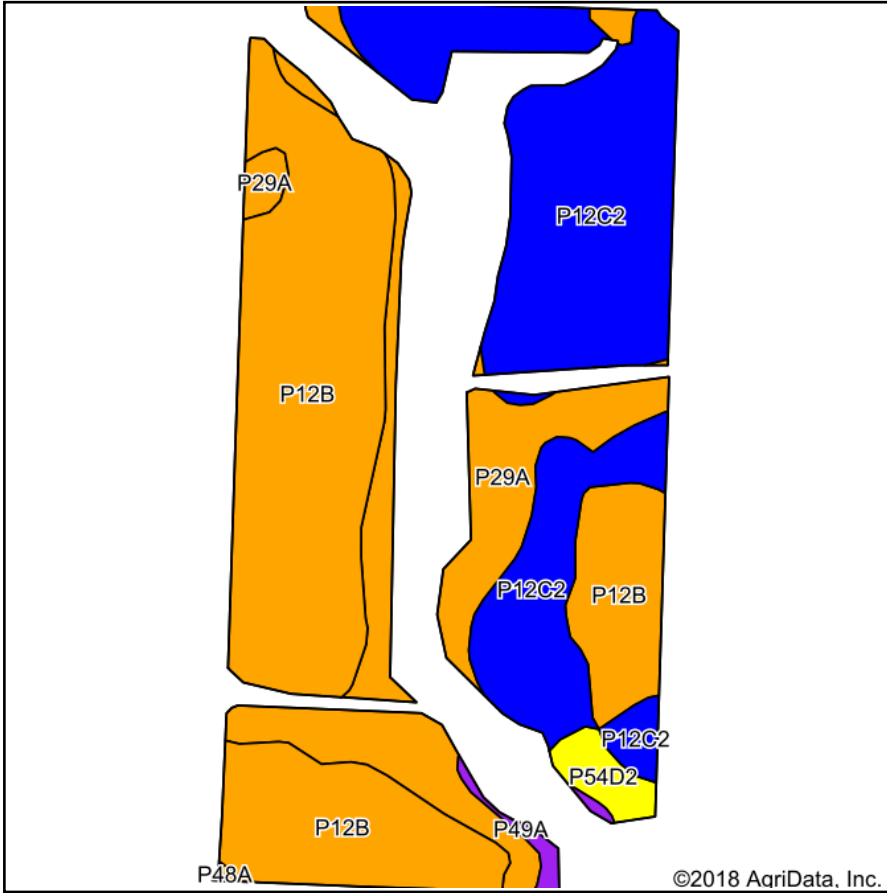

Soils data provided by USDA and NRCS.

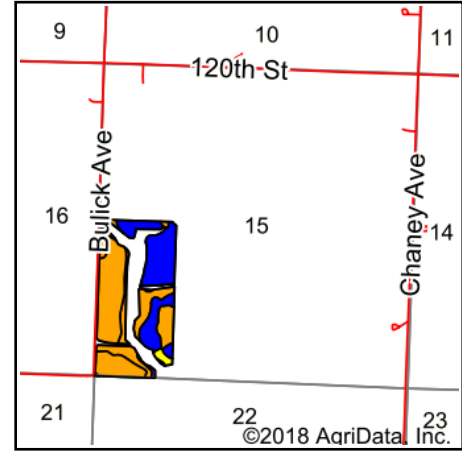

State: **Minnesota**
 County: **Nobles**
 Location: **15-104N-43W**
 Township: **Leota**
 Acres: **60.21**
 Date: **7/31/2018**



Maps Provided By:



Area Symbol: MN105, Soil Area Version: 15

Code	Soil Description	Acres	Percent of field	Non-Irr Class Legend	Non-Irr Class *c	Productivity Index
P12B	Everly silty clay loam, 2 to 6 percent slopes	26.95	44.8%		Ile	93
P12C2	Everly silty clay loam, 6 to 12 percent slopes, moderately eroded	20.29	33.7%		IIle	82
P29A	Rushmore silty clay loam, 0 to 2 percent slopes	11.35	18.9%		IIw	94
P54D2	Moneta-Everly complex, 12 to 18 percent slopes, moderately eroded	1.13	1.9%		IVe	61
P49A	Comfrey clay loam, 0 to 2 percent slopes, frequently flooded	0.49	0.8%		Vw	20
Weighted Average						88.3

*c: Using Capabilities Class Dominant Condition Aggregation Method

Soils data provided by USDA and NRCS.