

Soil Map

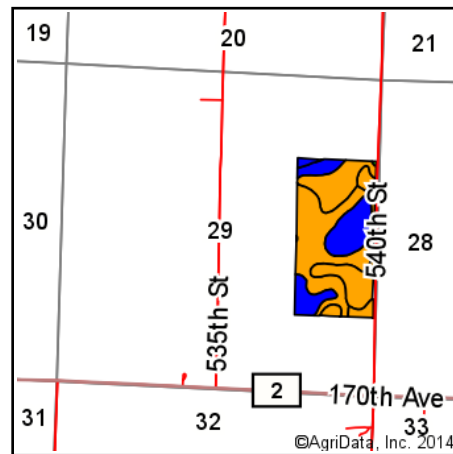

State: **Minnesota**
 County: **Yellow Medicine**
 Location: **29-114N-39W**
 Township: **Wood Lake**
 Acres: **78.75**
 Date: **7/17/2014**

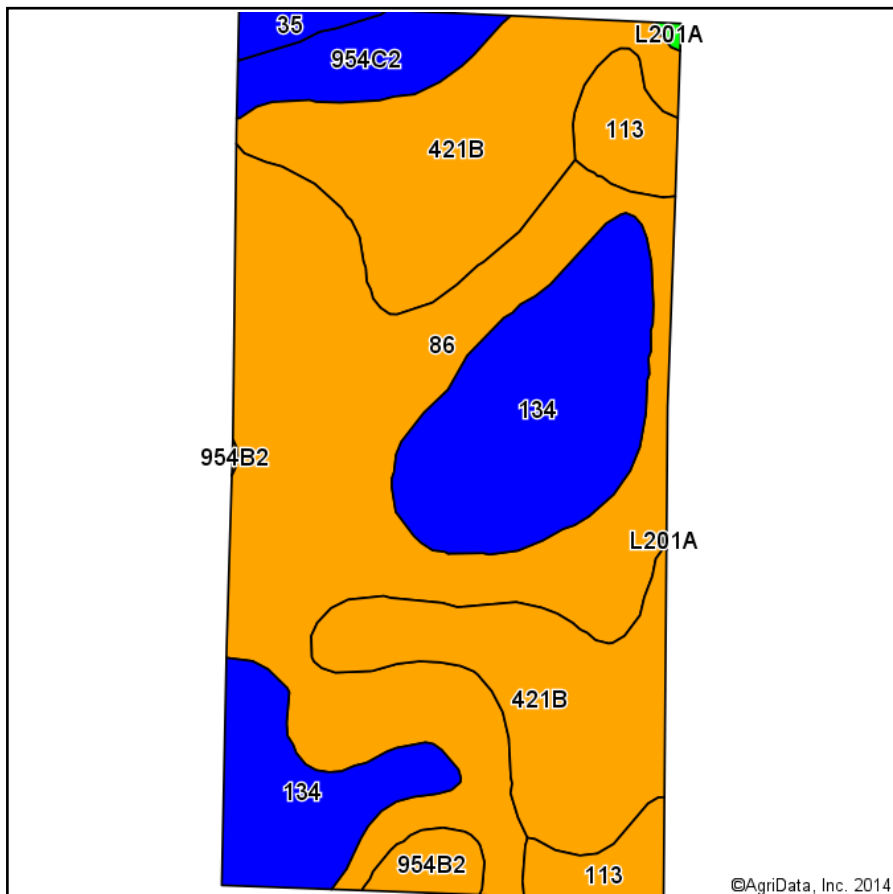
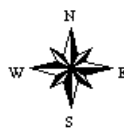

Viewing soils data as of 2/5/2014

Area Symbol: MN173, Soil Area Version: 7

Code	Soil Description	Acres	Percent of field	Non-Irr Class Legend	Non-Irr Class	Productivity Index	Corn	Soybeans
86	Canisteo clay loam	30.51	38.7%		IIw	93	170	51
421B	Ves loam, 1 to 4 percent slopes	21.73	27.6%		Ile	90	165	50
134	Okoboji silty clay loam	16.78	21.3%		IIIw	86	157	47
113	Webster clay loam	4.01	5.1%		IIw	93	170	51
954C2	Storden-Ves loams, 5 to 12 percent slopes, eroded	3.45	4.4%		IIIe	77	141	42
954B2	Ves-Storden loams, 3 to 6 percent slopes, eroded	1.26	1.6%		Ile	86	157	47
35	Blue Earth silt loam	0.90	1.1%		IIIw	77	141	42
L201A	Normania loam, 0 to 3 percent slopes	0.11	0.1%		I	99	181	54
Weighted Average						89.7	164.1	49.3

Area Symbol: MN173, Soil Area Version: 7

Field borders provided by Farm Service Agency as of 5/21/2008. Aerial photography provided by Aerial Photography Field Office.