

# Soils Map

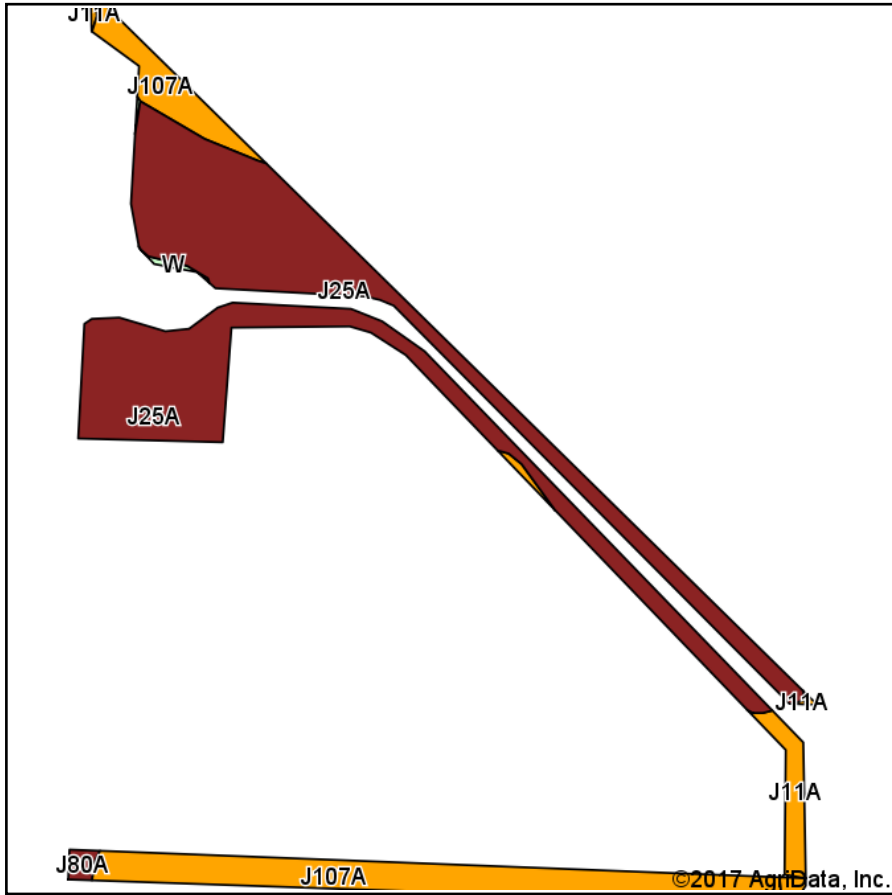

Soils data provided by USDA and NRCS.

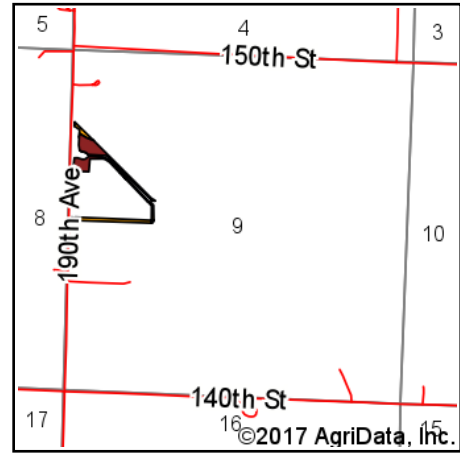

State: **Minnesota**  
 County: **Lyon**  
 Location: **9-109N-42W**  
 Township: **Rock Lake**  
 Acres: **6.6**  
 Date: **5/2/2017**



Maps Provided By:



© AgriData, Inc. 2017

www.AgriDataInc.com



## Area Symbol: MN083, Soil Area Version: 13

Code	Soil Description	Acres	Percent of field	Non-Irr Class Legend	Non-Irr Class *c	Productivity Index
J25A	Rauville silty clay loam, 0 to 1 percent slopes, frequently flooded	4.55	68.9%		VIw	20
J107A	Lakepark-Roliss-Parnell, depressional, complex, 0 to 3 percent slopes	1.74	26.4%		IIw	93
J11A	Vallers clay loam, 0 to 2 percent slopes	0.31	4.7%		IIw	90
<b>Weighted Average</b>						<b>42.5</b>

\*c: Using Capabilities Class Dominant Condition Aggregation Method

Soils data provided by USDA and NRCS.