

# Soils Map

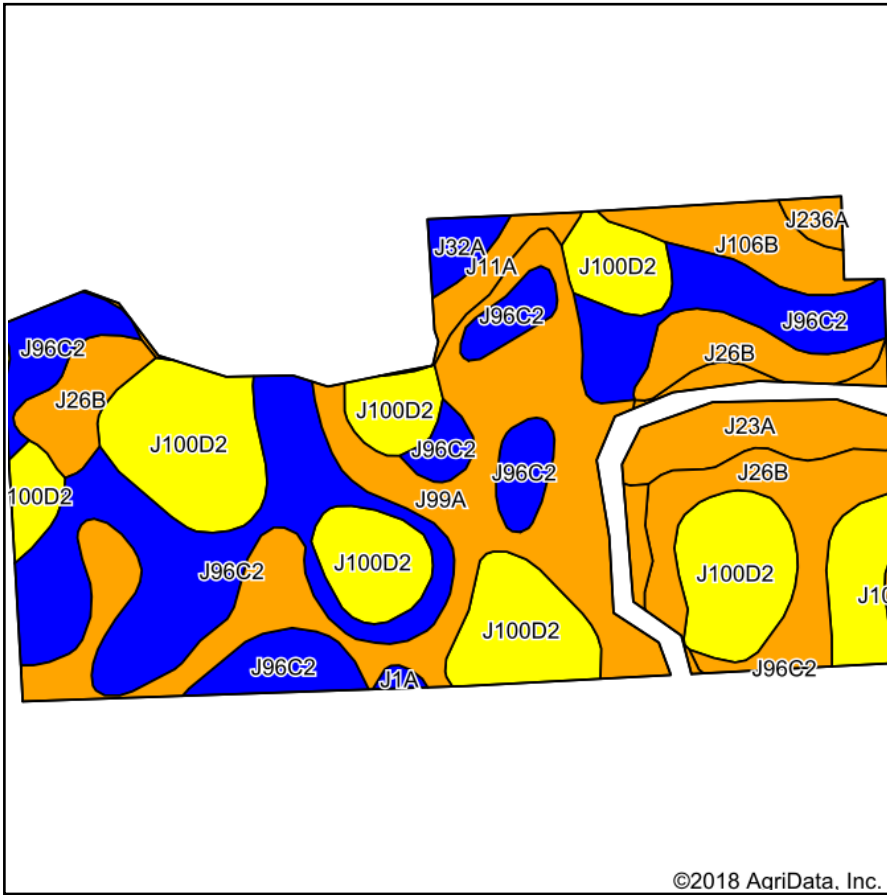

Soils data provided by USDA and NRCS.

©2018 AgriData, Inc.

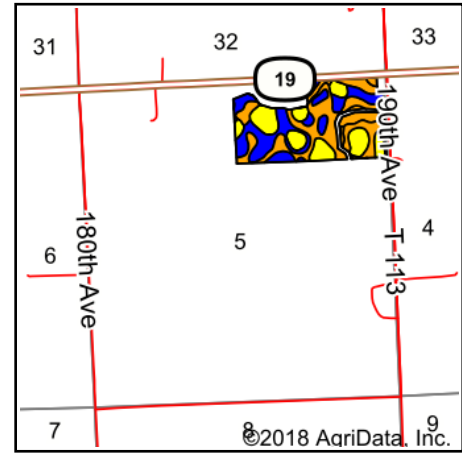

State: **Minnesota**  
 County: **Lincoln**  
 Location: **5-111N-45W**  
 Township: **Ash Lake**  
 Acres: **68.6**  
 Date: **7/24/2018**



Maps Provided By:



© AgriData, Inc. 2018

www.AgriDataInc.com



## Area Symbol: MN081, Soil Area Version: 15

Code	Soil Description	Acres	Percent of field	Non-Irr Class Legend	Non-Irr Class *c	Productivity Index
J96C2	Barnes-Buse complex, 6 to 12 percent slopes, moderately eroded	19.01	27.7%		IIIe	80
J100D2	Buse, eroded-Wilno complex, 12 to 18 percent slopes	18.51	27.0%		IVe	64
J99A	Lakepark clay loam, 0 to 3 percent slopes, overwash	14.19	20.7%		IIw	98
J26B	Damen loam, 2 to 6 percent slopes	8.52	12.4%		Ile	99
J23A	Lamoure silty clay loam, 0 to 2 percent slopes, occasionally flooded	3.34	4.9%		IIw	78
J106B	Barnes-Buse-Svea complex, 1 to 6 percent slopes	2.33	3.4%		Ile	88
J11A	Vallers clay loam, 0 to 2 percent slopes	1.09	1.6%		IIw	90
J32A	Bigstone silty clay loam, depressional, 0 to 1 percent slopes	0.79	1.2%		IIIw	77
J236A	Highpoint Lake silty clay, 0 to 2 percent slopes	0.47	0.7%		IIs	90
J101B	Hokans-Svea complex, 1 to 4 percent slopes	0.18	0.3%		Ile	98
J1A	Parnell silty clay loam, depressional, 0 to 1 percent slopes	0.17	0.2%		IIIw	86
<b>Weighted Average</b>						<b>82.2</b>

\*c: Using Capabilities Class Dominant Condition Aggregation Method

Soils data provided by USDA and NRCS.